

**CHERRYWOOD PARK - PHASE 1
PLAYGROUND REVITALIZATION
FILING NO 2 LOT 28, BLOCK 13
LOCATED IN CHERRYWOOD PARK, SOUTHWEST OF PRAIRIE HILLS ELEMENTARY SCHOOL
CITY OF THORNTON, COUNTY OF ADAMS, STATE OF COLORADO
13807 MADISON STREET.**

FINAL PLANS

GENERAL NOTES

- CONTRACTOR SHALL VERIFY WITH OWNER'S REPRESENTATIVE THAT PLANS ARE CURRENT AND APPROVED.
- CONTRACTOR IS RESPONSIBLE FOR QUANTITIES AND MATERIAL CALCULATIONS. IF THERE IS A DISCREPANCY BETWEEN A WRITTEN QUANTITY AND THE PLAN DRAWINGS, THE PLAN DRAWINGS SHALL TAKE PRECEDENCE.
- WORK SHALL BE IN ACCORDANCE WITH THE REQUIREMENTS OF THE CITY OF THORNTON. ANY VARIATIONS FROM THE APPROVED LANDSCAPE PLAN NEED TO BE APPROVED BY THE CITY OF THORNTON.
- THE CONTRACTOR SHALL OBTAIN ALL NECESSARY AND/OR REQUIRED PERMITS AND PAY ALL RELATED FEES AND/OR TAXES REQUIRED TO INSTALL THE WORK ON THE PLANS.
- THE CONTRACTOR SHALL BE APPROPRIATELY LICENSED AS REQUIRED BY THE CITY.
- CONTRACTOR SHALL NOTIFY THE OWNER'S REPRESENTATIVE IMMEDIATELY OF ANY ERRORS, OMISSIONS OR DISCREPANCIES IN EXISTING CONDITIONS OR WITH THE PLANS PRIOR TO THE BEGINNING OF WORK.
- UNIT PRICES FOR ALL IMPROVEMENTS SHALL BE ESTABLISHED AS A PART OF THE CONTRACT WITH THE OWNER'S REPRESENTATIVE PRIOR TO BEGINNING WORK, TO ACCOMMODATE ADDITIONS AND/OR DELETIONS OF MATERIAL AND/OR LABOR.
- DETERMINATION OF "EQUAL" SUBSTITUTIONS SHALL BE MADE ONLY BY THE CITY OF THORNTON..
- SITE OBSERVATIONS BY THE CIVIL ENGINEER / LANDSCAPE ARCHITECT / OWNER DURING ANY PHASE OF THIS PROJECT DOES NOT RELIEVE THE CONTRACTOR OF THEIR PRIMARY RESPONSIBILITY TO PERFORM ALL WORK IN ACCORDANCE WITH THE PLANS, SPECIFICATIONS AND GOVERNING CODES. ANY WORK NOT IN COMPLIANCE MAY BE REJECTED AT ANY TIME.
- ALL EXISTING UTILITIES AND STRUCTURES REPORTED BY OWNERS OR OTHERS AND THOSE SHOWN ON RECORDS EXAMINED, ARE INDICATED ON THE PLAN WITH THEIR APPROXIMATE LOCATION AND EXTENT. UNDERGROUND FACILITIES MAY EXIST WHICH HAVE NOT BEEN REPORTED OR OF RECORD. THE CONTRACTOR IS REQUIRED TO TAKE DUE PRECAUTIONARY MEASURES TO PROTECT THOSE FACILITIES FOUND AT THE SITE. IT SHALL BE THE CONTRACTOR'S RESPONSIBILITY TO NOTIFY THE OWNER'S OF THESE FACILITIES BEFORE STARTING WORK. CAUTION BEFORE EXCAVATION. VERIFY THE LOCATION OF UNDERGROUND UTILITIES. AT LEAST TWO (2) WORKING DAYS PRIOR TO EXCAVATION, THE CONTRACTOR SHALL REQUEST MARK OUT OF UNDERGROUND UTILITIES BY CALLING 811.
- AS-BUILT DRAWINGS: A SET PDFS AND AUTOCAD DRAWINGS AND A SET OF SPECIFICATIONS SHALL BE KEPT AT ALL TIMES ON WHICH ALL CHANGES OR VARIATIONS IN THE WORK INCLUDING ALL EXISTING UTILITIES ARE TO BE RECORDED. AS BUILT DRAWINGS SHALL BE PROVIDED TO THE CITY OF THORNTON BEFORE INITIAL ACCEPTANCE OF THE CONSTRUCTION BY THE OWNER'S REPRESENTATIVE.
- CONTRACTOR AGREES THAT THEY SHALL ASSUME SOLE AND COMPLETE RESPONSIBILITY FOR JOB SITE CONDITIONS DURING THE COURSE OF CONSTRUCTION OF THIS PROJECT. THIS INCLUDES THE SAFETY OF ALL PERSONS AND PROPERTY. THIS REQUIREMENT SHALL APPLY CONTINUOUSLY AND SHALL NOT BE LIMITED TO NORMAL WORKING HOURS.
- CONTRACTOR SHALL ARRANGE ALL SITE ACCESS, SECURITY, STAGING, SAFETY AND EROSION CONTROLS WITH THORNTON PRIOR TO STARTING PROJECT.
- ALL CLASSIFICATION TESTING SHALL BE PERFORMED BY A QUALIFIED INDEPENDENT TESTING LABORATORY UNDER THE SUPERVISION OF A REGISTERED PE SPECIALIZING IN SOILS ENGINEERING AT THE EXPENSE OF THE RESPONSIBLE PARTY. THE RESPONSIBLE PARTY SHALL COORDINATE WITH AND FULLY COMPLY WITH ALL RECOMMENDATIONS MADE BY THE TESTING AGENCY.
- FOR ALL CONCRETE WORK: CONCRETE SHALL HAVE FIBER MESH REINFORCEMENT, SHALL BE 4500 PSI AFTER 28 DAYS OF CURING. AND ALL JOINTS SHALL BE SAW CUT. CONTRACTOR MUST BE PREPARED TO SHOW RESULTS OF CONCRETE TESTING UPON REQUEST, PER CITY OF THORNTON STANDARD 609.4.
- SUBSTANTIAL COMPLETION WILL BE ISSUED AT THE COMPLETION OF ALL CONSTRUCTION OPERATIONS UNDER THIS CONTRACT, AND PROJECT IS OPEN TO THE PUBLIC. PRIOR TO THE BEGINNING OF THE POST-CONSTRUCTION WARRANTY PERIOD, AN INSPECTION WILL BE PERFORMED (OR INITIAL ACCEPTANCE WALK-THROUGH). THE CITY WILL, UPON 7 DAYS ADVANCE NOTICE, MAKE INSPECTION OF THE WORK TO DETERMINE ACCEPTABILITY. THE CITY WILL PREPARE A "PUNCH LIST" OF ITEMS IMPROPERLY INSTALLED, INADEQUATELY SIZED OR OTHERWISE DEFICIENT. THE "PUNCH LIST" DEFICIENCIES SHALL BE CORRECTED NOT MORE THAN 21 CALENDAR DAYS AFTER THE INSPECTION.
- PRIOR TO THE DATE OF THE WALK-THROUGH AND AS A CONDITION OF RECEIVING INITIAL ACCEPTANCE, THE CONTRACTOR SHALL CONVEY TO THE CITY THE JOB RECORD SET OF ALL CHANGES MADE TO ALL PLANS DURING THE CONSTRUCTION PERIOD, LABELING SAID PRINTS "AS-BUILT". ALL TURNOVER ITEMS NOTED IN OTHER SPECIFICATION SECTIONS SHALL BE DELIVERED PRIOR TO THIS INSPECTION.
- WORK REQUIRING CORRECTIVE ACTION SHALL BE PERFORMED WITHIN THE FIRST 21 DAYS AFTER THE INITIAL ACCEPTANCE INSPECTION. IF CORRECTIVE WORK IS NOT COMPLETED WITHIN THE TIMEFRAME STATED IN THE GENERAL CONDITIONS OR 21 DAYS WHICHEVER IS THE LEAST, THEN ANOTHER WALK-THROUGH WILL BE REQUIRED AND A NEW "PUNCH LIST" OF DEFICIENCIES, AS WELL AS AN EQUIVALENT EXTENSION OF THE GUARANTEE PERIOD, WILL BE REQUIRED AT NO ADDITIONAL COST TO THE CITY.
- THE IMPROVEMENTS WILL BE INITIALLY ACCEPTED BY THE CITY WHEN ALL IMPROVEMENTS AND PUNCH LIST ITEMS ARE SATISFACTORILY COMPLETED IN ACCORDANCE WITH THE TERMS OF THE APPROVED CONSTRUCTION DRAWINGS, AND APPLICABLE CITY STANDARDS AND SPECIFICATIONS. IF, AFTER THE INSPECTION, THE CITY IS OF THE OPINION THAT ALL WORK HAS BEEN PERFORMED AS PER THE CONTRACT DOCUMENTS, THE CITY WILL GIVE THE CONTRACTOR WRITTEN NOTICE OF INITIAL ACCEPTANCE SIGNIFYING COMMENCEMENT OF THE ONE-YEAR GUARANTEE PERIOD.



VICINITY MAP
NOT TO SCALE



OWNER

THE CITY OF THORNTON

LANDSCAPE ARCHITECT:

RICK ENGINEERING COMPANY
5690 WEBSTER STREET
ARVADA, CO 80002

Phone: (303) 403-2405
CONTACT: MICHELLE CASE, MLA &
MICHAEL TAYLOR, PLA

CIVIL ENGINEER

RICK ENGINEERING COMPANY
5690 WEBSTER STREET
ARVADA, CO 80002

PHONE: (303) 403-2425
CONTACT: ALEX POTVIN, PE

SURVEYOR

RICK ENGINEERING COMPANY
5690 WEBSTER STREET
ARVADA, CO 80002

PHONE: (303) 403-2433
CONTACT: ROBERT HENNESSY, PLS

WORK TO BE DONE

THE SCOPE OF WORK ASSOCIATED WITH THESE PLANS CONSISTS OF PUBLIC IMPROVEMENTS FOR THE CHERRYWOOD PARK PLAYGROUND REDEVELOPMENT. THIS PROJECT CONSISTS OF DEMOLITION OF AN EXISTING PLAYGROUND, AND INSTALLATION OF A NEW PLAYGROUND, INCLUDING AMONG OTHER THINGS 2 CONCRETE STAGES, ARTIFICIAL TURF MOUNDS, SHADE STRUCTURES, SEAT BOULDER, SEAT STUMPS, MUSICAL INSTRUMENTS, LANDSCAPE BOULDERS, AND SURFACE TREATMENTS. LANDSCAPE AND PARK IMPROVEMENTS IN ACCORDANCE WITH THE FOLLOWING PLANS, SPECIFICATIONS AND STANDARD DRAWINGS OF THE CITY OF THORNTON, COUNTY OF ADAMS, COLORADO.

SHEET INDEX

SHEET NO.	SHEET NAME	DESCRIPTION
1	CS-01	COVER SHEET
2	D-01	DEMOLITION & TREE PRESERVATION
3	LS-01	PLAYGROUND PLAN
4	LS-02	HARDSCAPE PLAN
5	LS-03	DRAINAGE PLAN
6	LD-01	LANDSCAPE DETAILS - 1
7	LD-02	LANDSCAPE DETAILS - 2
8	LD-03	LANDSCAPE DETAILS - 3
9	LD-04	EQUIPMENT DETAILS - 1
10	LD-05	EQUIPMENT DETAILS - 2

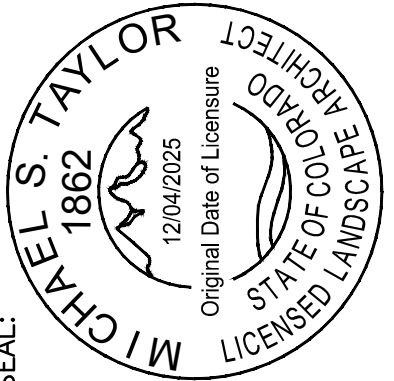

RICK ENGINEERING COMPANY
5690 WEBSTER STREET
ARVADA, CO 80002
303-423-6036
rickengineering.com

SAN DIEGO ORANGE RIVERSIDE SACRAMENTO SAN LUIS OBISPO
SANTA CLARITA PHOENIX TUCSON LAS VEGAS DENVER

PROJECT NO: 22090
DATE: 05/07/2026
DRAWN/DESIGNED BY: [Name]
CHECKED BY: [Name]
MST/TH

CHERRYWOOD PARK - PHASE 1
PLAYGROUND REVITALIZATION
CITY OF THORNTON
13807 MADISON STREET, THORNTON, CO 80602

COVER SHEET



C:\RICK\Projects\22090-D_CherrywoodPark\Landscape\4_FDP\7_Sheets\22090D_COVER.dwg - plotted by: mcase ON 2026-05-07 @ 14:53 - ctbrec.ncs_v2.ctb - © 2026 Rick Engineering Company

C:\RICK\Projects\020000\2209-D_CherrywoodPark_Landscape\4_FDP\4_Sheets\2209D-LSPLAN.dwg - plotted by: mcase ON 2026-05-07 @ 14:58 - cbrrec_ncs_v2.ctb - © 2026 Rick Engineering Company

LEGEND

	NEW CONCRETE	(A-C) LD-01	(A-B) LD-02
	STABILIZED GRAY CRUSHER FINES	(C) LD-02	
	SHREDDED CEDAR MULCH	(D) LD-02	
	ARTIFICIAL TURF	(A-E) LD-03	
	ENGINEERED WOOD FIBER	(A,G) LD-01	
	BLUE/BLACK 50/50 DURA PLAY OR APPROVED EQUAL	(C-D) LD-01	
	WASHED PEA GRAVEL	(H) LD-01	

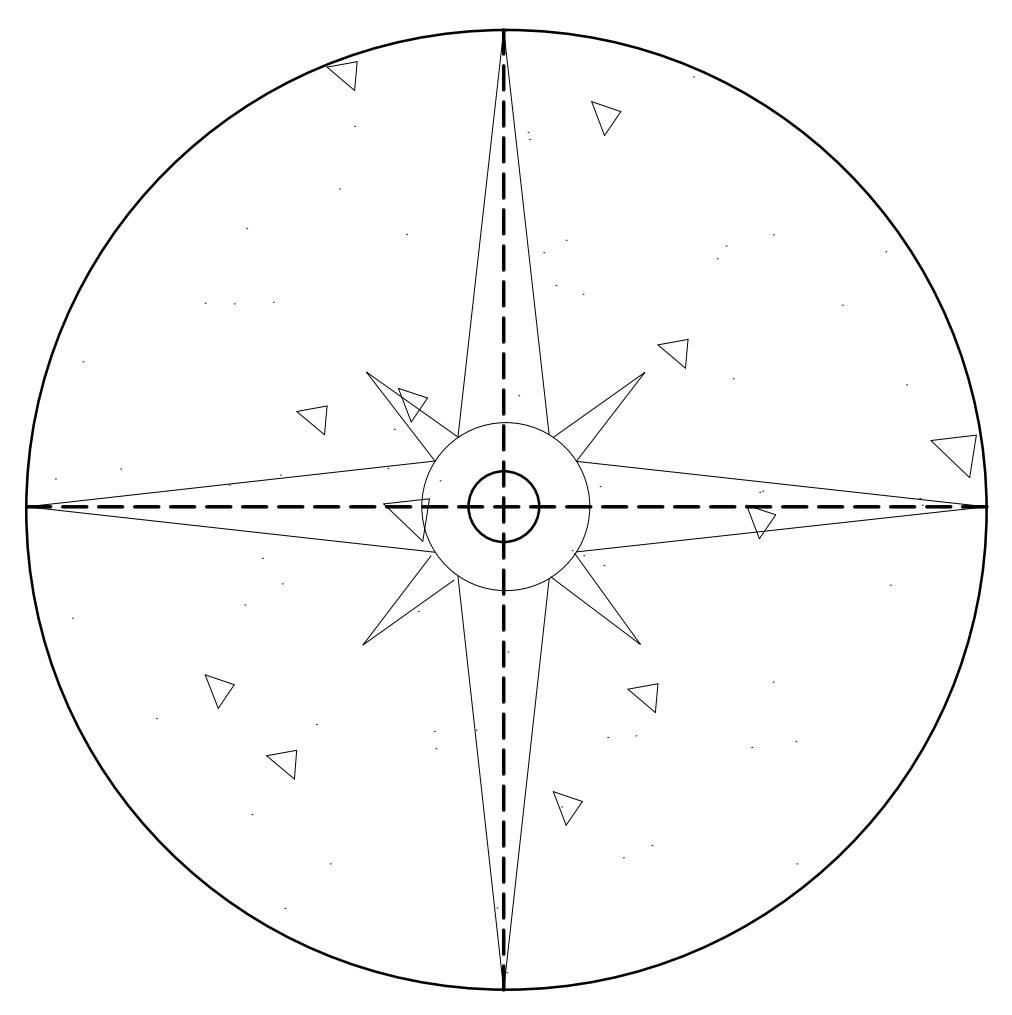
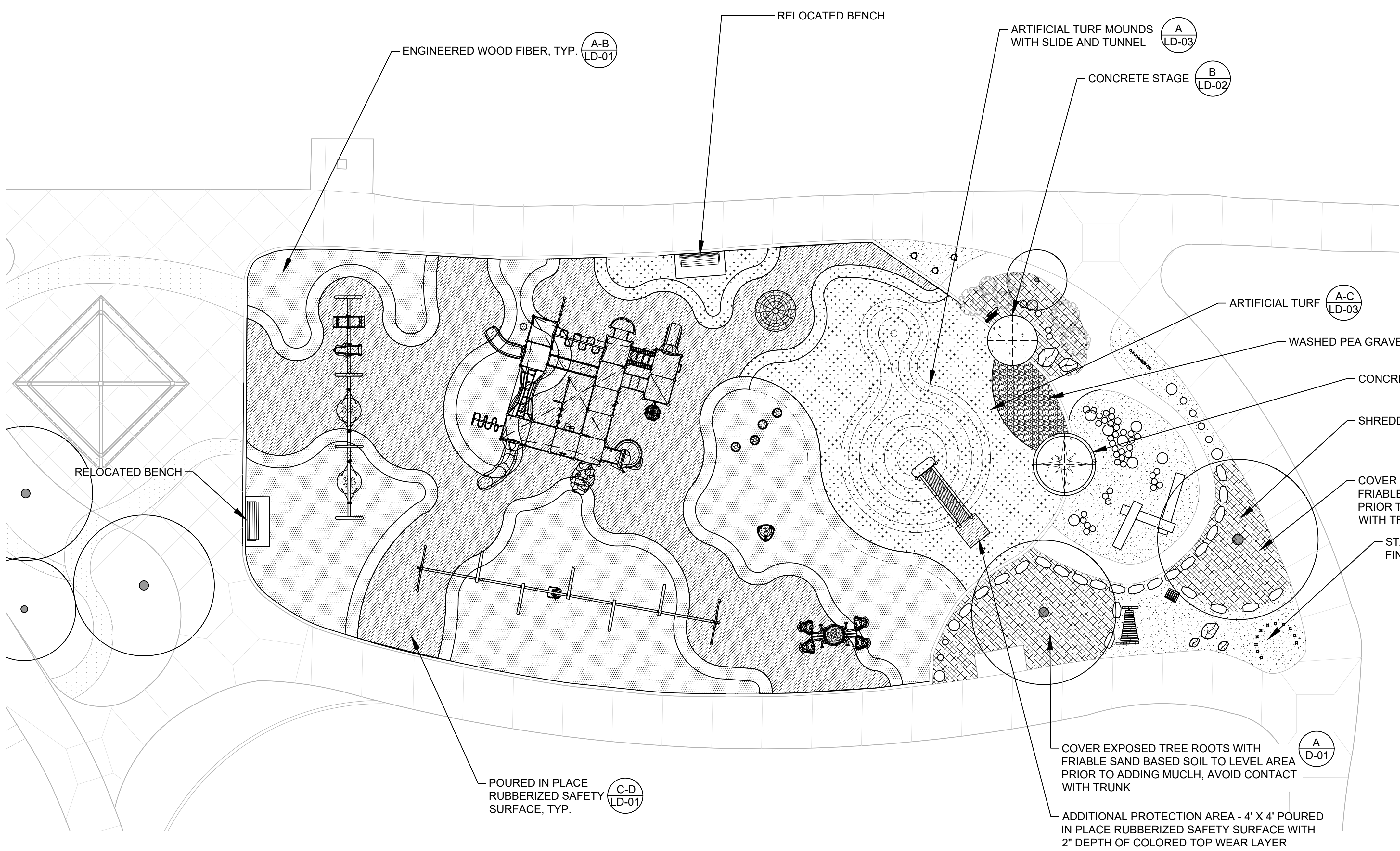

(A) STAGE PAVING ENLARGEMENT
NTS

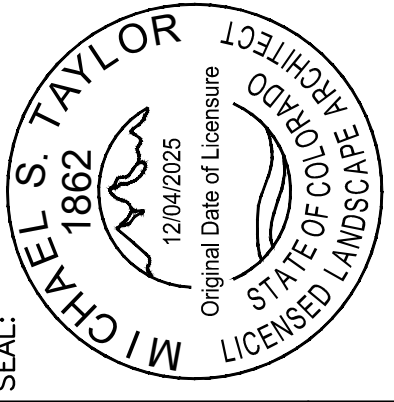
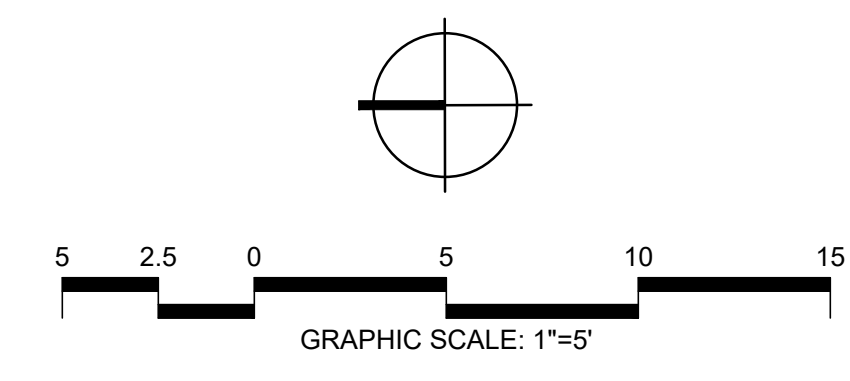

SEAL: MICHAEL S. TAYLOR
1862
12042025
Original Date of Licensure
STATE OF COLORADO
LICENSED LANDSCAPE ARCHITECT

5690 WEBSTER STREET
ARVADA, CO 80002

303-423-6036
rickengineering.com

SAN DIEGO ORANGE RIVERSIDE SACRAMENTO SAN LUIS OBISPO
SANTA CLARITA PHOENIX TUCSON LAS VEGAS DENVER

PROJECT NO: 2209D | DRAWN/DESIGNED BY: MC
DATE: 05/07/2026 | CHECKED BY: MST/TH

CHERRYWOOD PARK - PHASE 1
PLAYGROUND REVITALIZATION
CITY OF THORNTON
13607 MADISON STREET, THORNTON, CO 80602

HARDSCAPE PLAN

811
Know what's below.
Call before you dig.

DRAWING NO.
LS - 02
SHEET NO. 04 OF 10

C:\Rick\Projects\2209-D_CherrywoodPark\landscape\4-FDP\7_Sheets\2209D-LSPLAN.dwg - plotted by: mcase ON 2026-05-07 @ 14:54 - ctbrrec_nrs_v2.ctb - ©2026 Rick Engineering Company

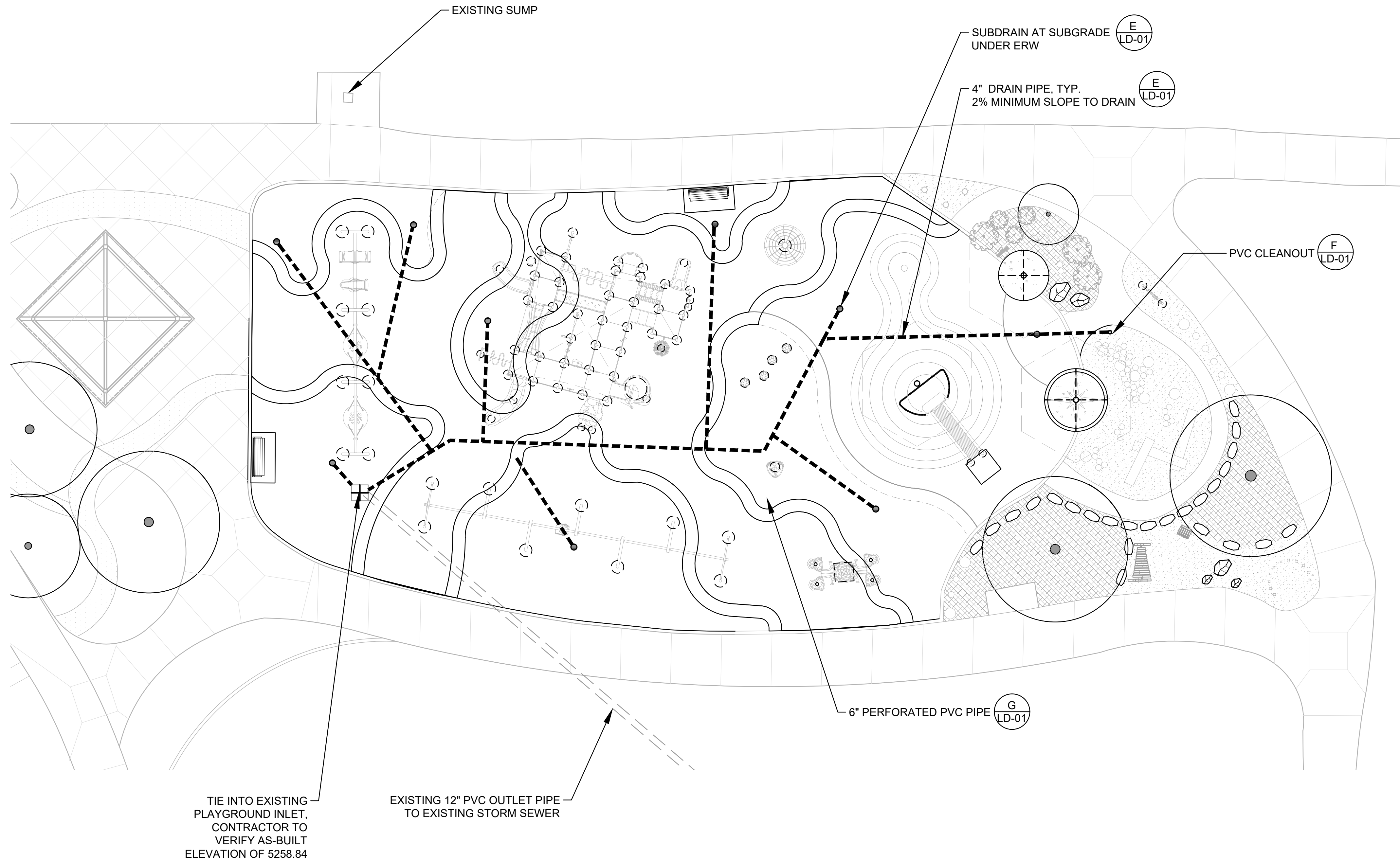

DRAINAGE NOTES:

1. PERFORATED DRAIN PIPE SHALL BE INSTALLED ACROSS SLOPE AND AVOID PLAY EQUIPMENT FOOTINGS. FIELD ADJUST AS NEEDED. THE MAXIMUM DISTANCE BETWEEN PERFORATED PIPES IS TO BE 20.'
2. THE 6" PVC PERFORATED COLLECTION PIPE SHALL BE INSTALLED TO AVOID CONFLICTS WITH FOOTINGS. FIELD ADJUST AS NEEDED.
3. ALL PERFORATED PIPE SHALL BE INSTALLED WITH PERFORATIONS FACING DOWNWARDS.

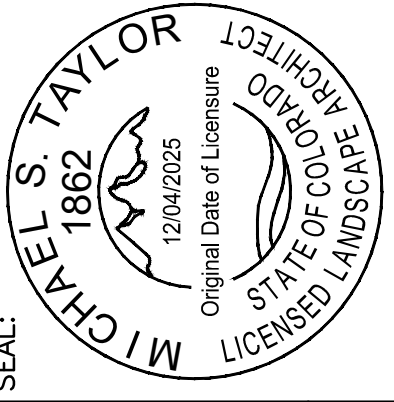
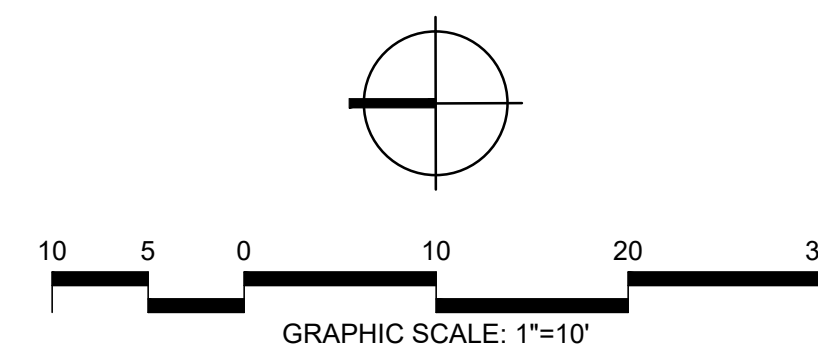

RICK
 303-423-6036
 rickengineering.com
 5690 WEBSTER STREET
 ARVADA, CO 80002
 SAN DIEGO ORANGE RIVERSIDE SACRAMENTO SAN LUIS OBISPO
 SANTA CLARITA PHOENIX TUCSON LAS VEGAS DENVER

PROJECT NO: 2209D | DRAWN/DESIGNED BY: MC
 DATE: 05/07/2026 | CHECKED BY: MST/TH

CHERRYWOOD PARK - PHASE 1
 PLAYGROUND REVITALIZATION
 CITY OF THORNTON
 13607 MADISON STREET, THORNTON, CO 80602

DRAINAGE PLAN



NO.	BY	DATE	REVISION

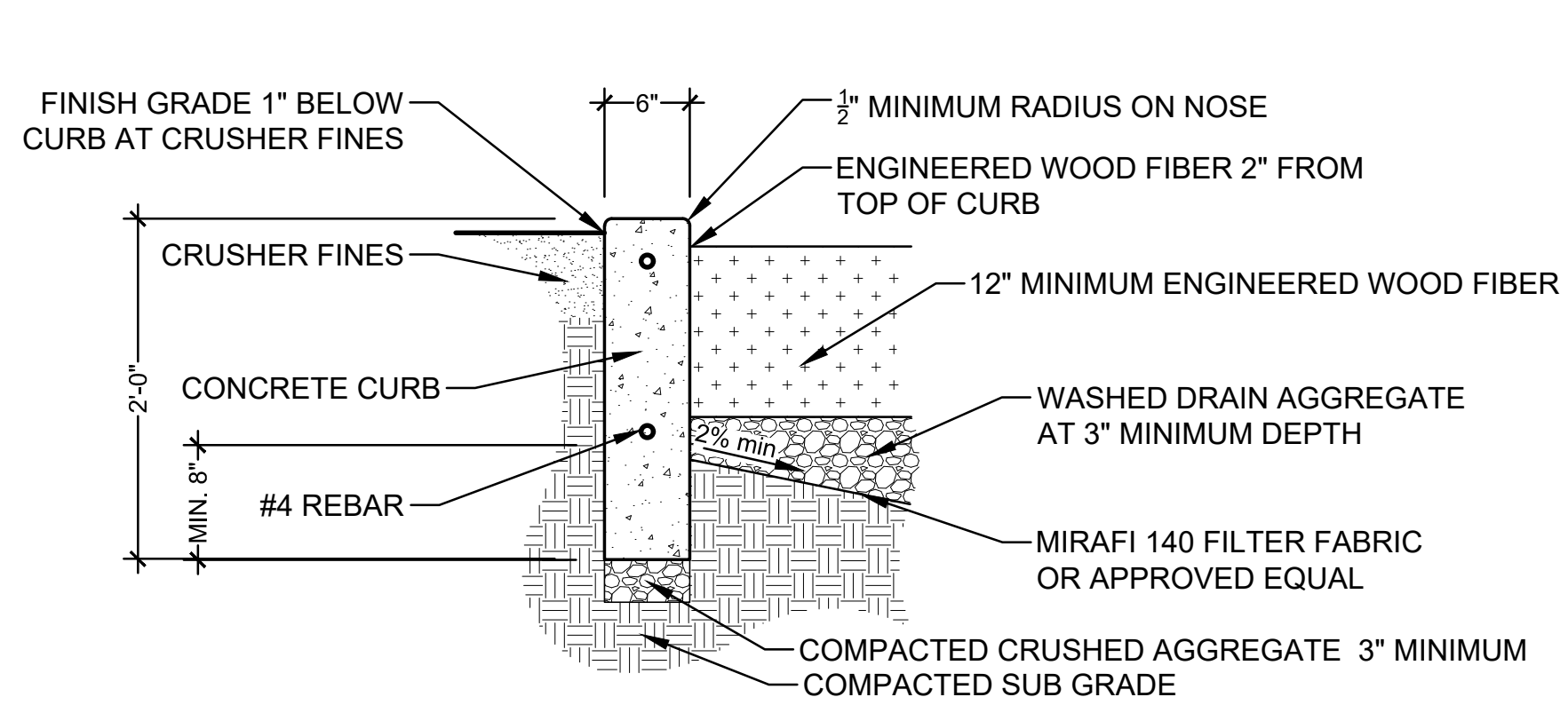

A PLAYGROUND CURB AT CRUSHER FINES NTS

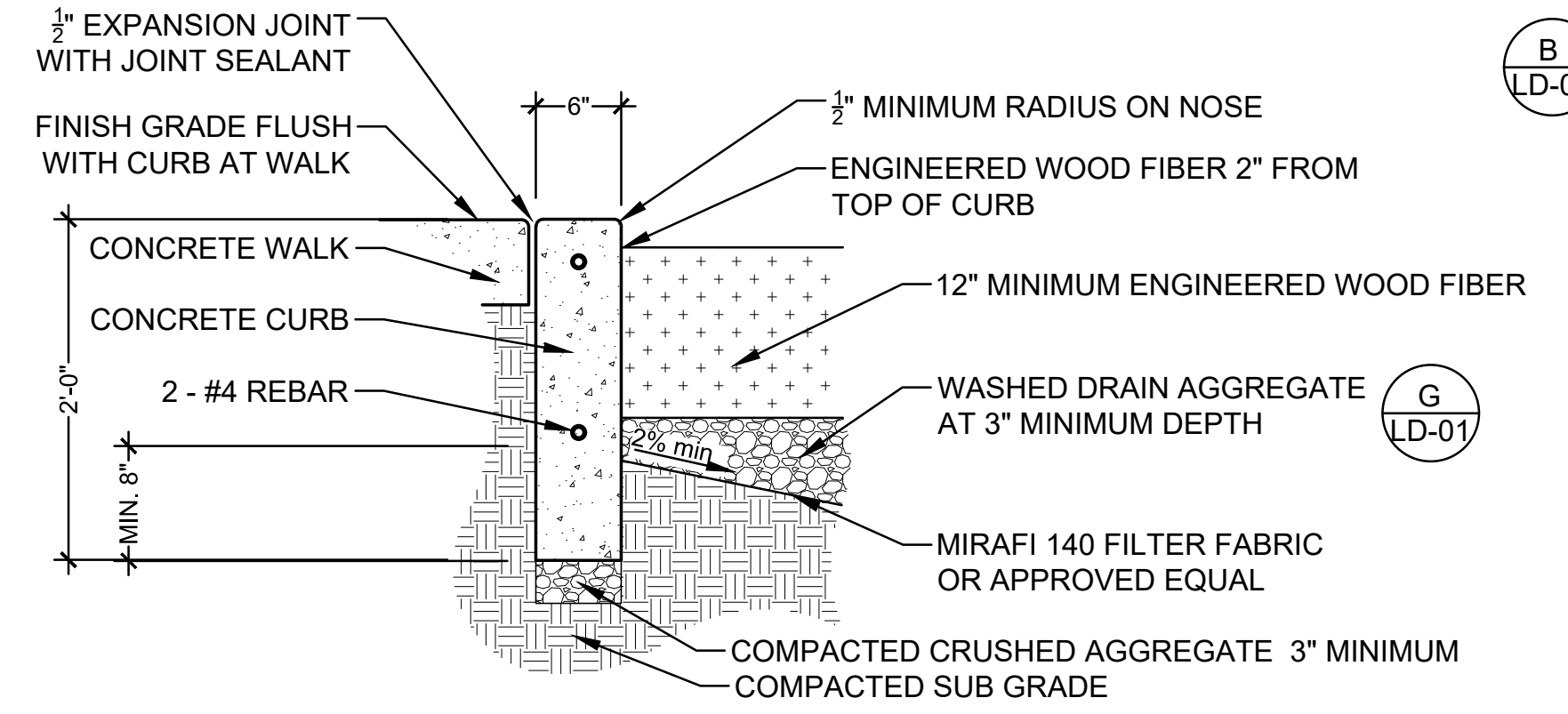

B PLAYGROUND CURB AT WALK NTS

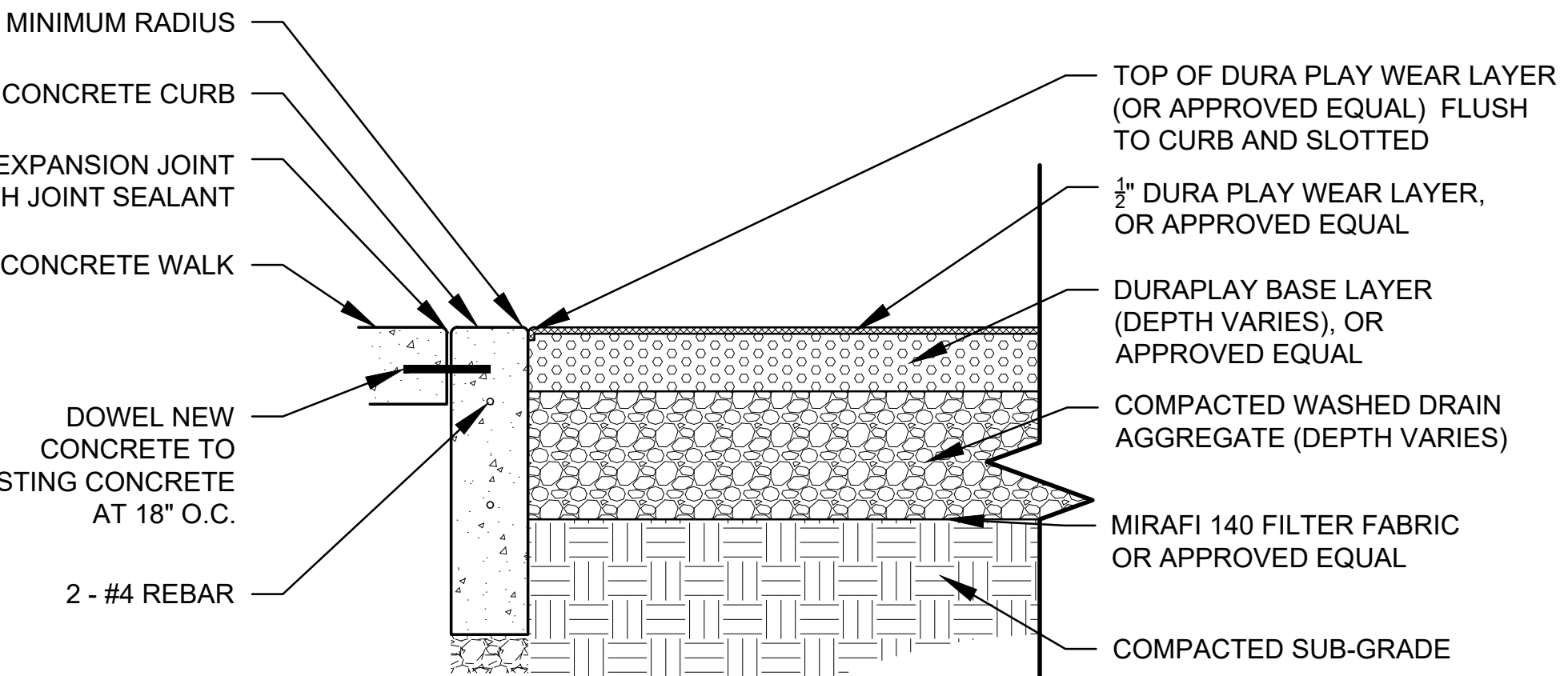

C PLAYGROUND CURB AT POURED-IN-PLACE SAFETY SURFACE NTS

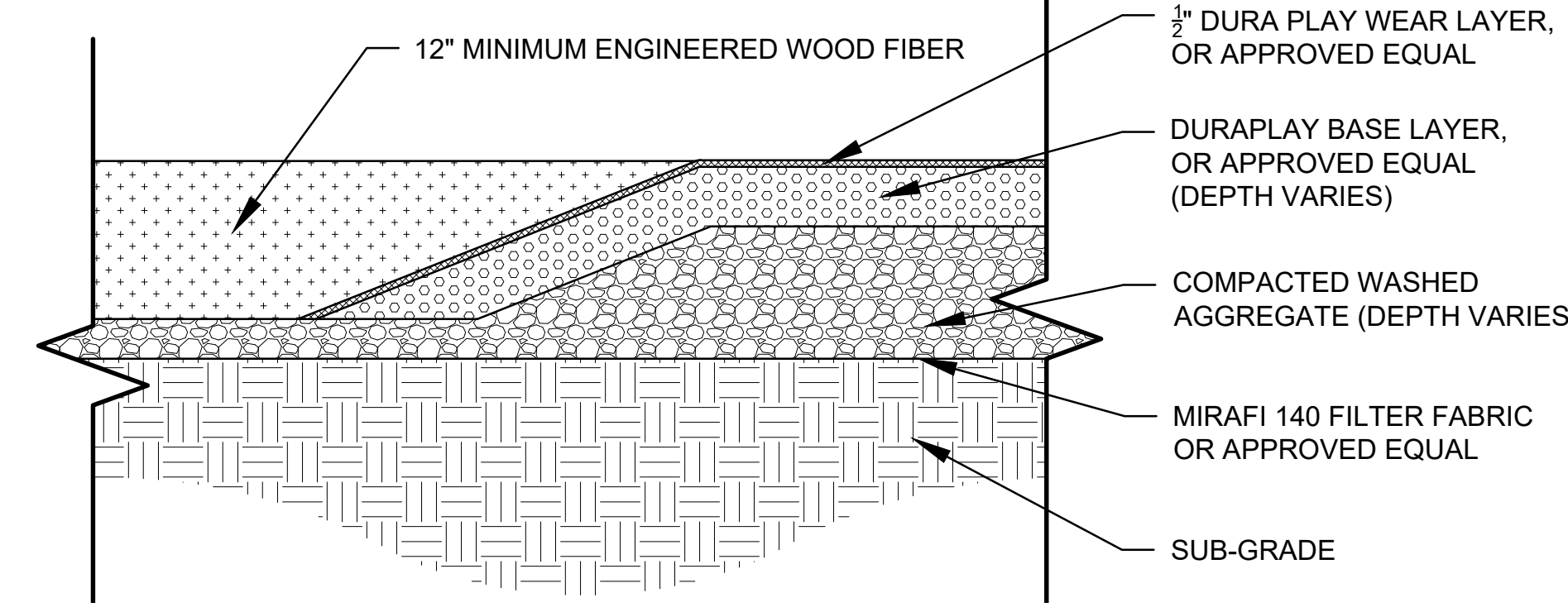

D POURED-IN-PLACE TRANSITION TO ENGINEERED WOOD FIBER NTS

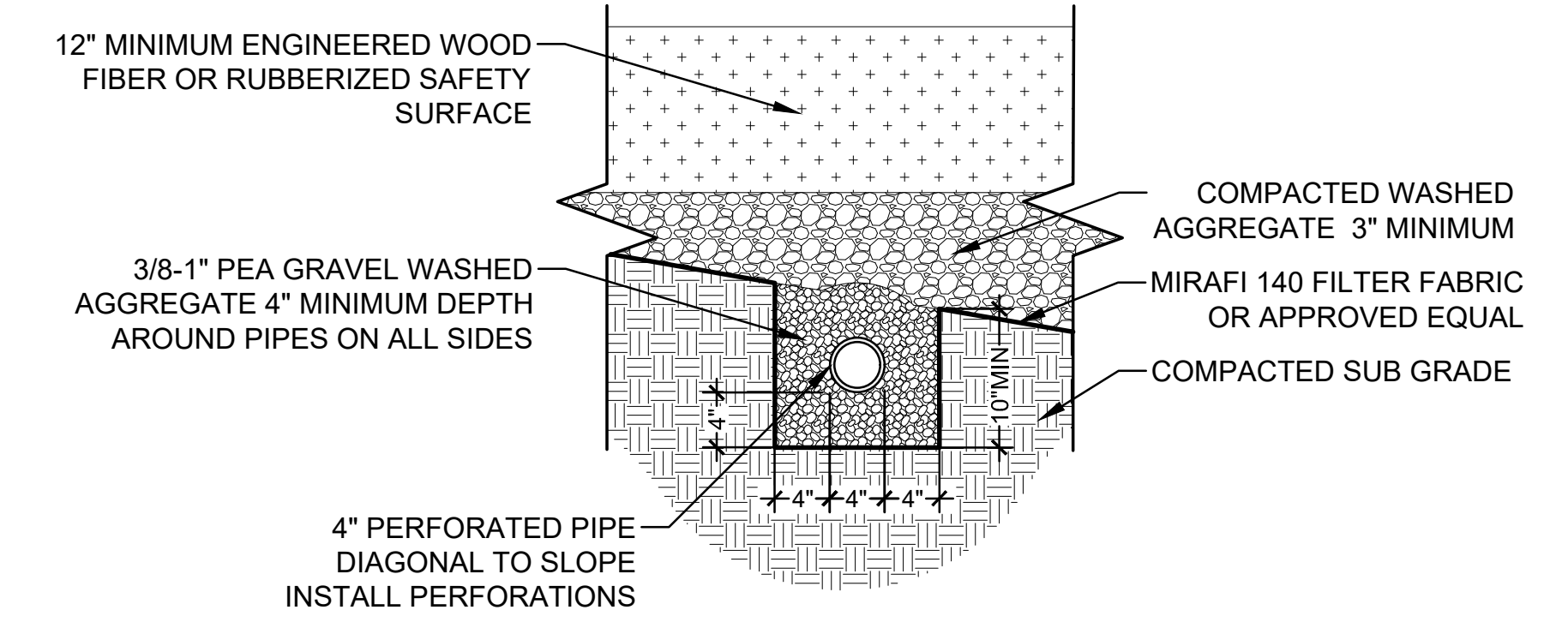

E 4" PERFORATED PIPE CROSS SECTION NTS

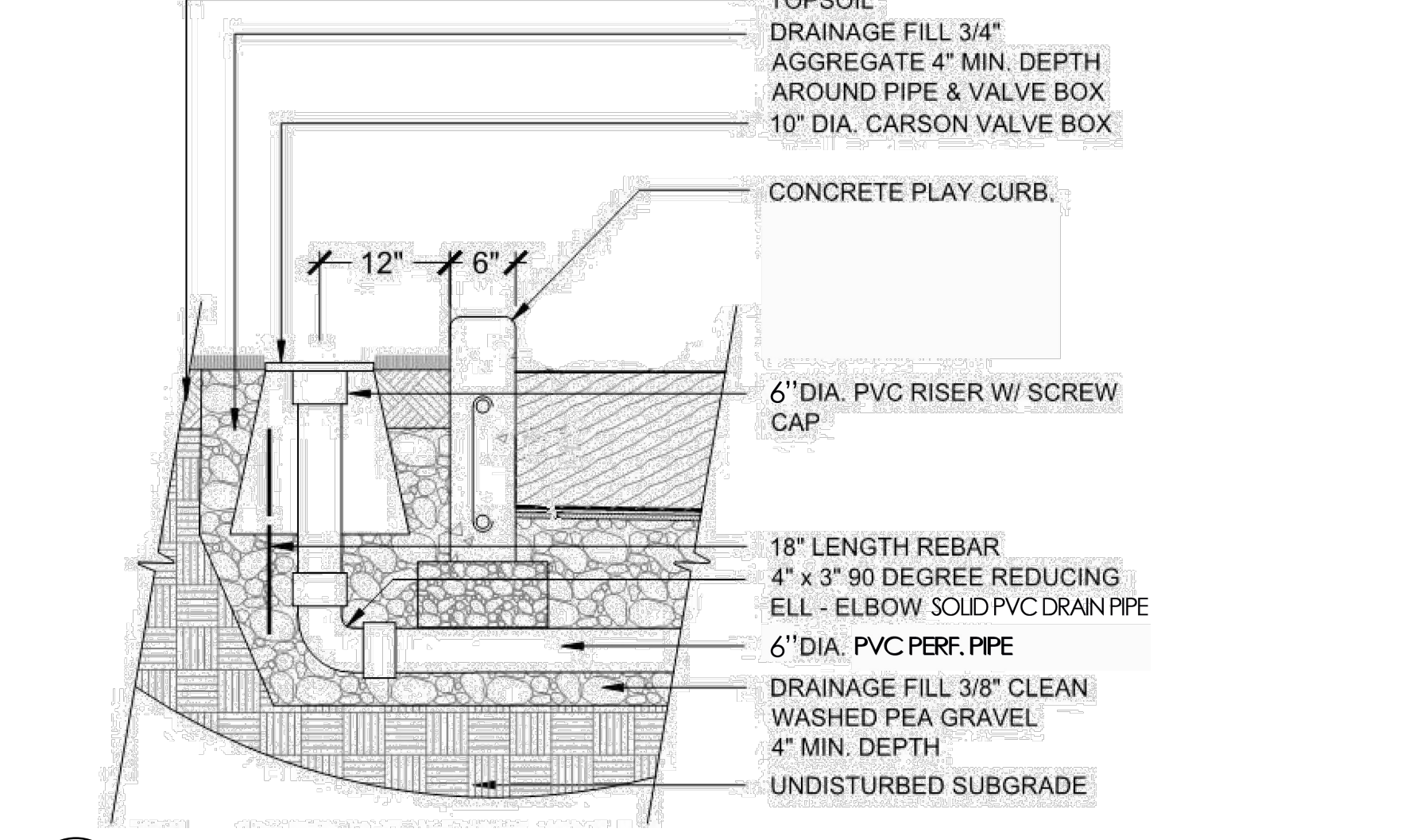

F DRAIN CLEAN OUT DETAIL NTS

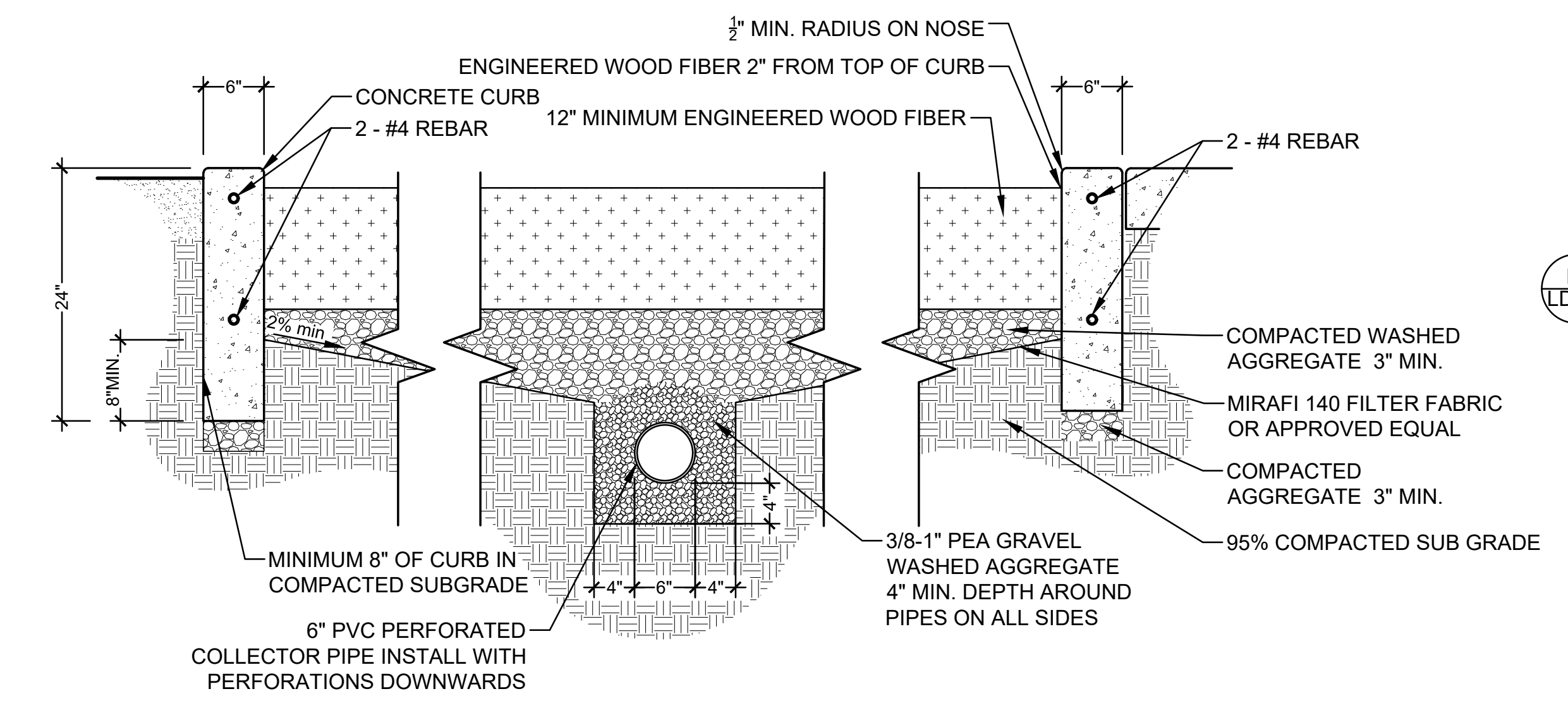

G 6" PERFORATED PVC DRAINAGE PIPE CROSS SECTION NTS

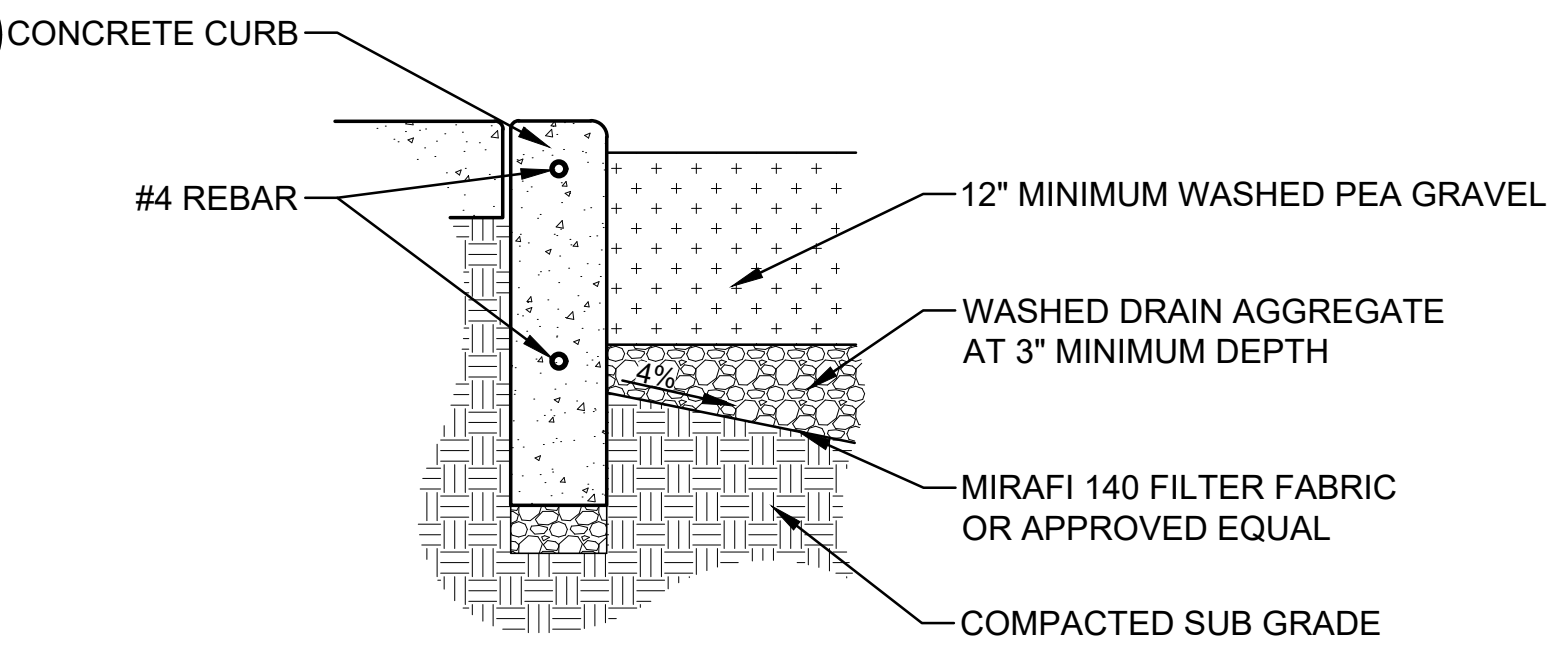

H PEA GRAVEL NTS

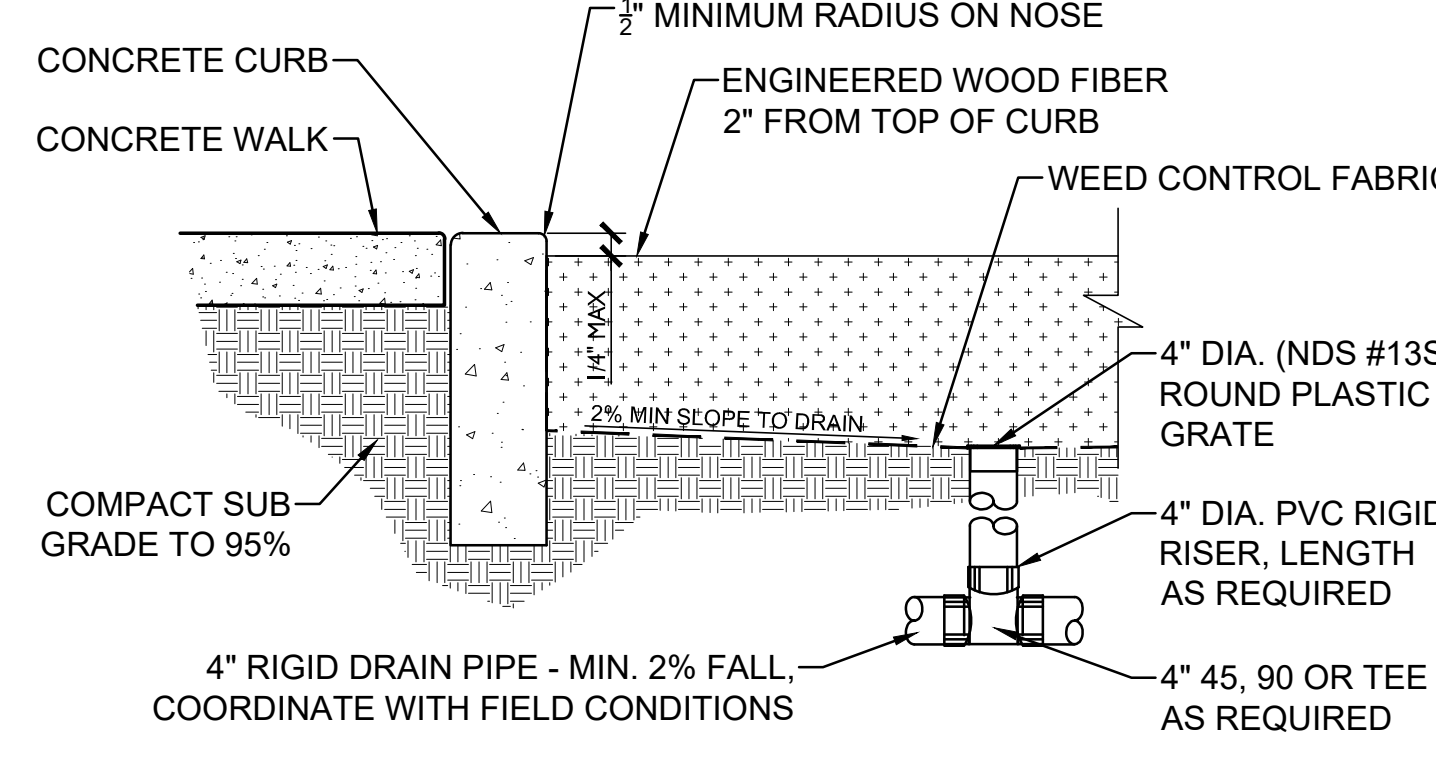

I ENGINEERED WOOD FIBER AT PLAY AREA NTS

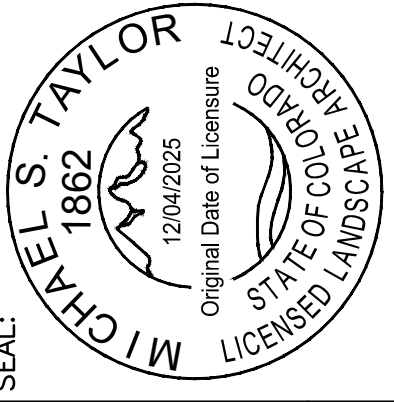

SEAL: MICHAEL S. TAYLOR 1862 12042025 Original Date of Licensure STATE OF COLORADO LICENSED LANDSCAPE ARCHITECT

5690 WEBSTER STREET ARVADA, CO 80002
303-423-6036 rickengineering.com

SAN DIEGO ORANGE RIVERSIDE SACRAMENTO SAN LUIS OBISPO
SANTA CLARITA PHOENIX TUCSON LAS VEGAS DENVER

PROJECT NO: 22090 DRAWN/DESIGNED BY: MC
DATE: 05/07/2026 CHECKED BY: MST/TH

CHERRYWOOD PARK - PHASE 1
PLAYGROUND REVITALIZATION
CITY OF THORNTON
13607 MADISON STREET, THORNTON, CO 80602

LANDSCAPE DETAILS - 1



C:\RICK\Projects\22090-D_CherrywoodPark_Landscape_4_FDP7_Sheets\22090-LSDETAIL.dwg - plotted by: mcase ON 2026-05-07 @ 14:54 - c:\brec_ncs_v2.ctb - © 2026 Rick Engineering Company

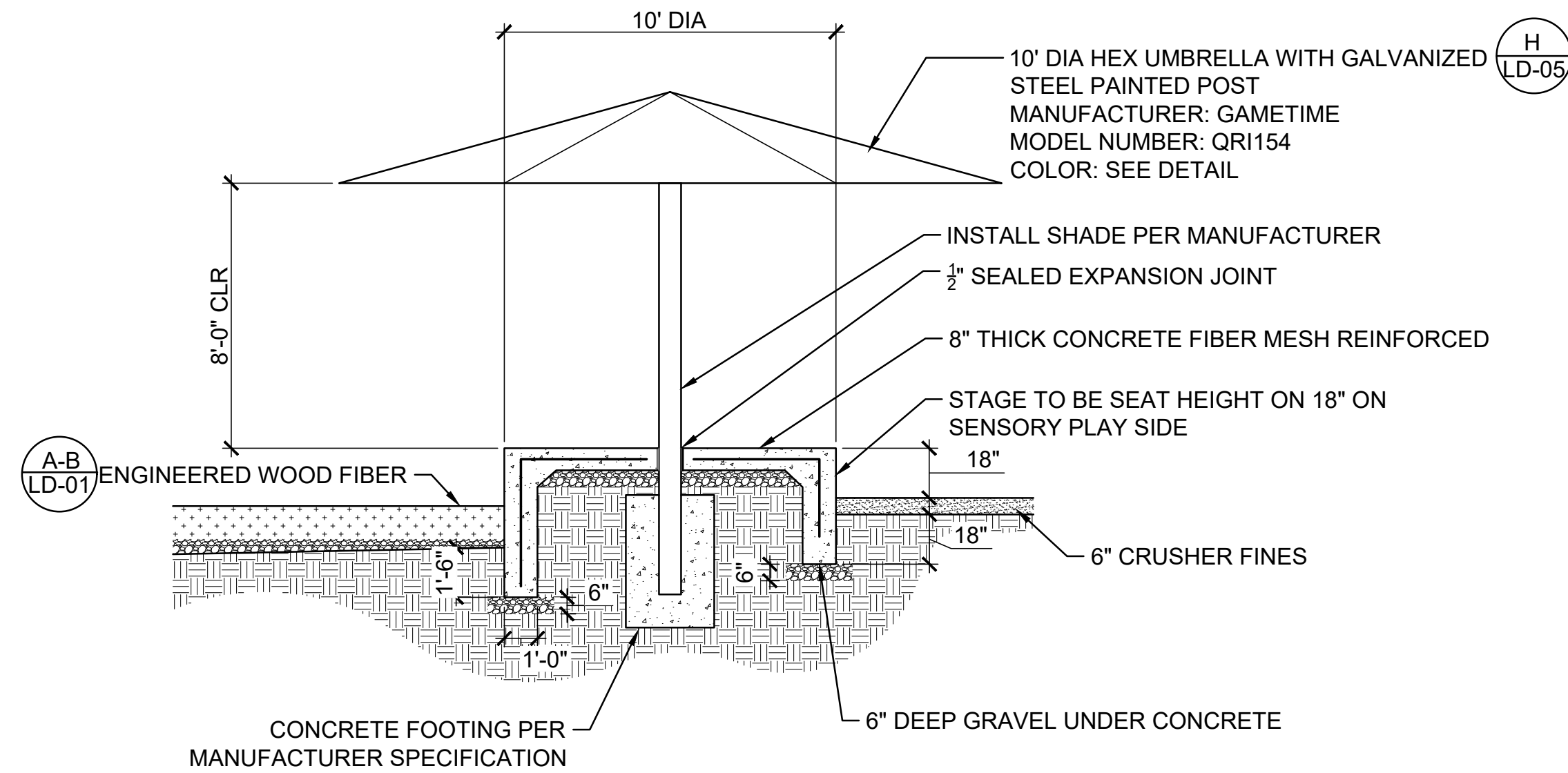

A CONCRETE STAGE SECTION - 10' DIAMETER

NTS

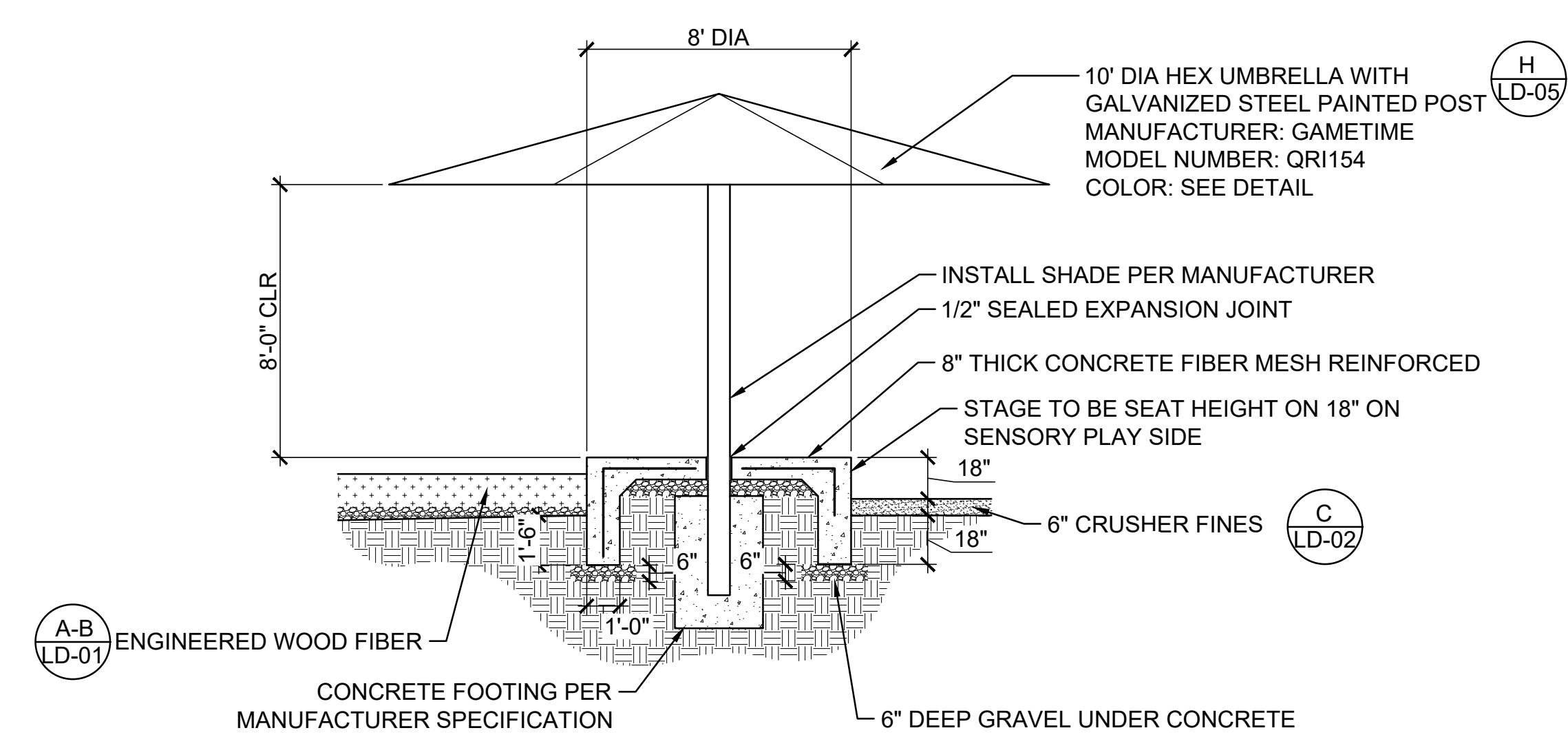

B CONCRETE STAGE SECTION - 8' DIAMETER

NTS

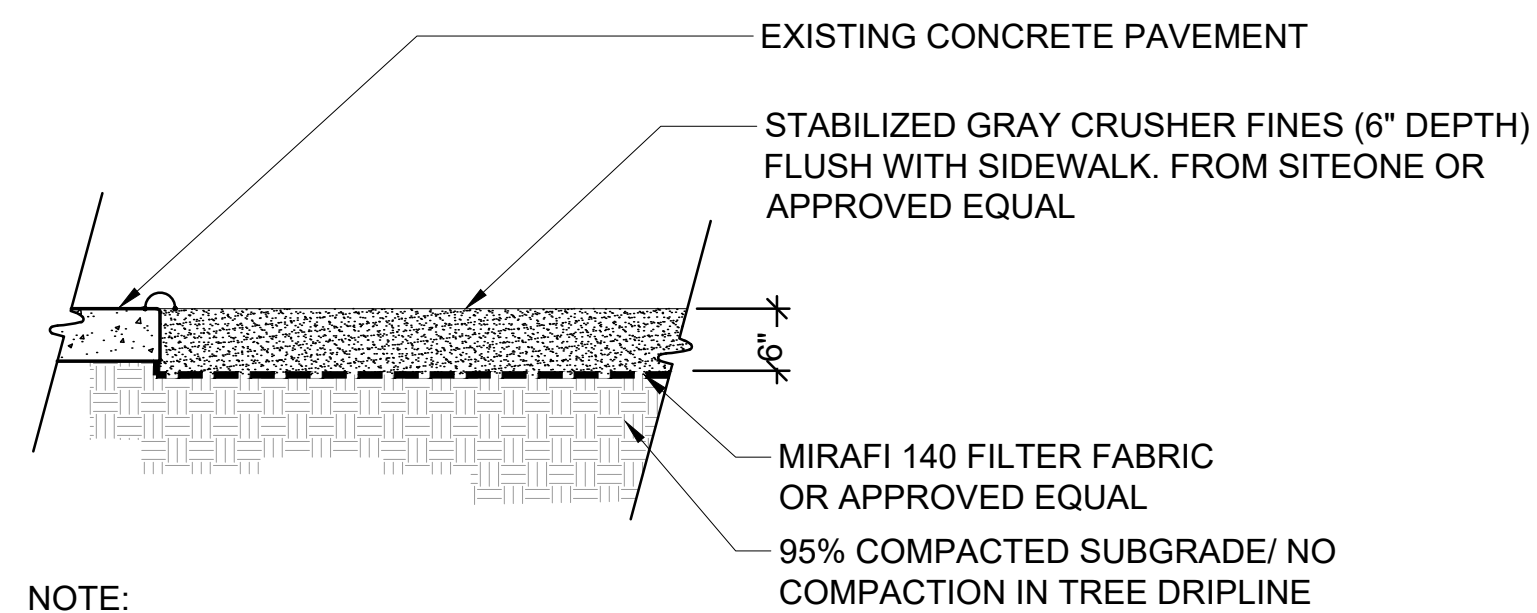

C STABILIZED CRUSHER FINES - GRAY

NTS

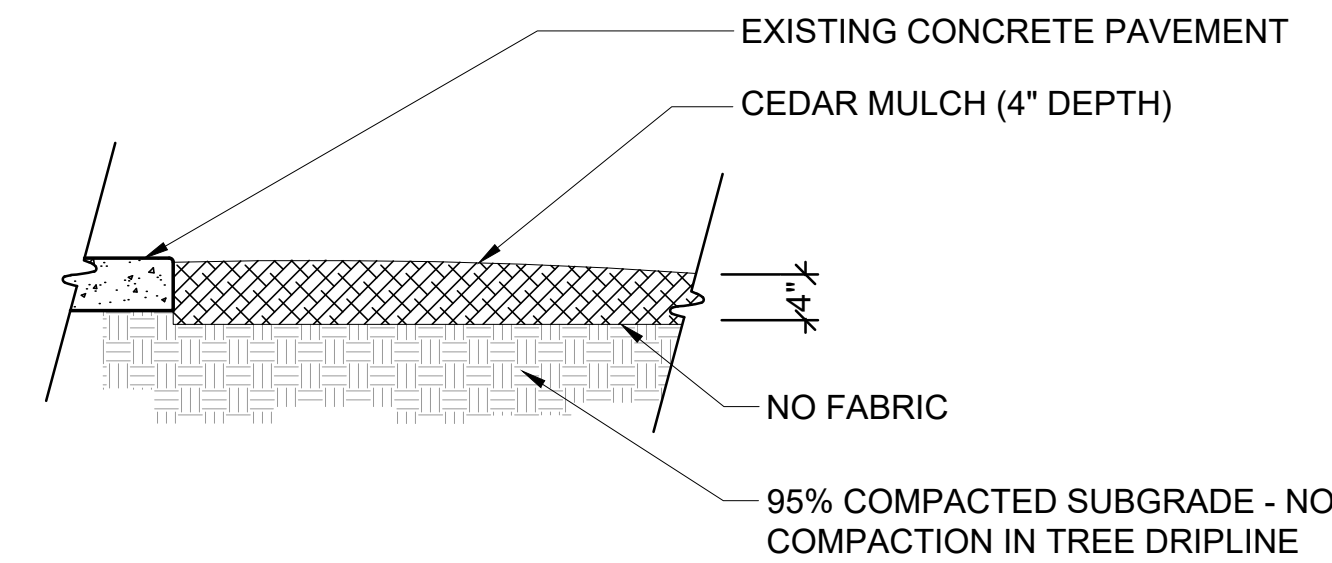

D SHREDDED CEDAR MULCH

NTS

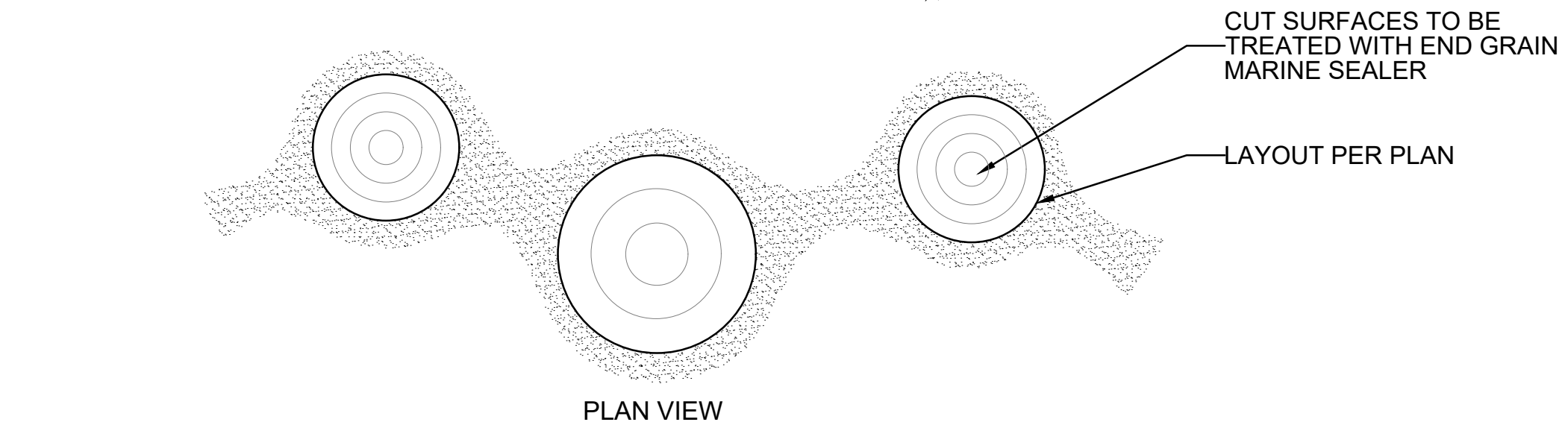
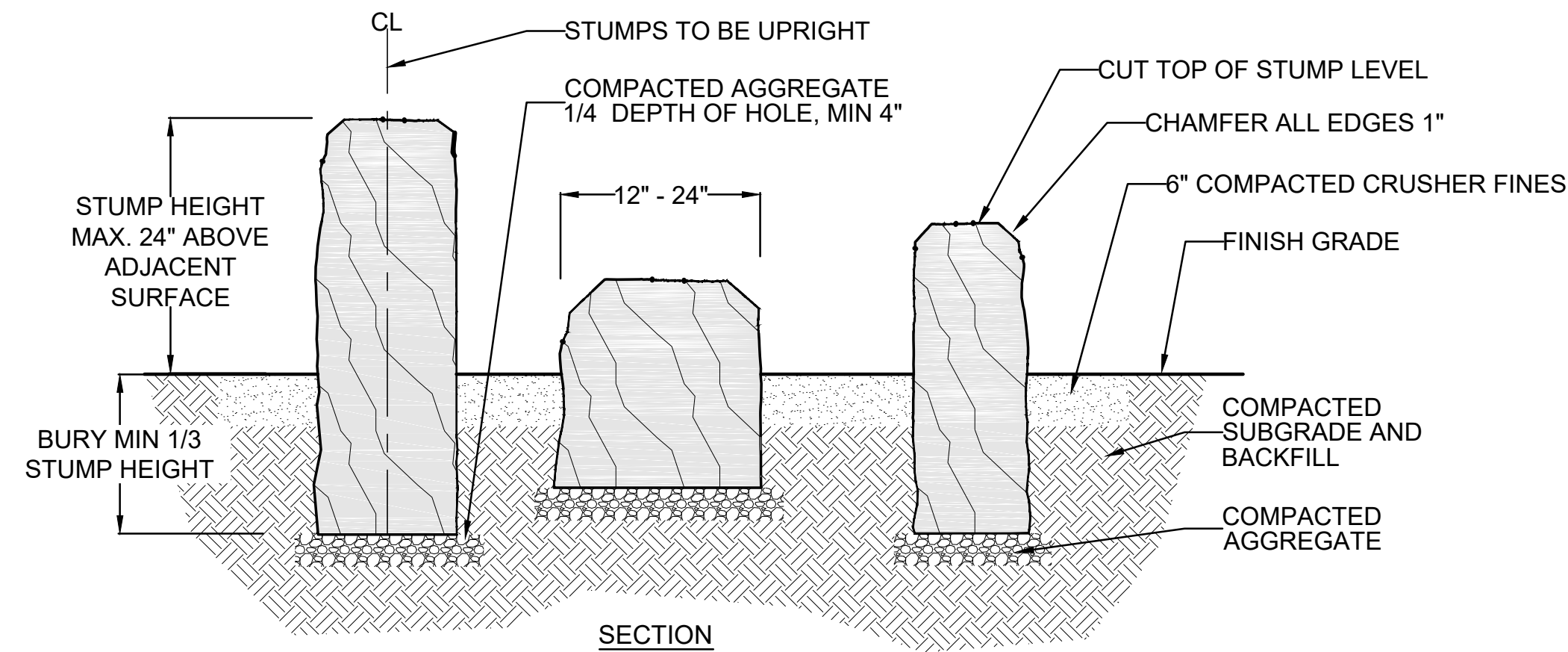

- NOTES:
- LOG SIZE AND SHAPE WILL VARY. STUMPS WILL BE OF ROBINIA WOOD WITH BARK.
 - SEE PLANS FOR STUMP LOCATIONS. COORDINATE WITH PROJECT MANAGER ANY CONFLICTS WITH TREE ROOTS.
 - CONTRACTOR TO ENSURE ALL STUMP EDGES ARE CHAMFERED, SANDED AND FREE FROM SPLINTERS. REMOVE ALL BRANCHES.
 - ALL SURFACES BELOW GRADE SHALL BE SEALED WITH A MARINE GRADE SEALANT.

F STUMP SEATS

NTS

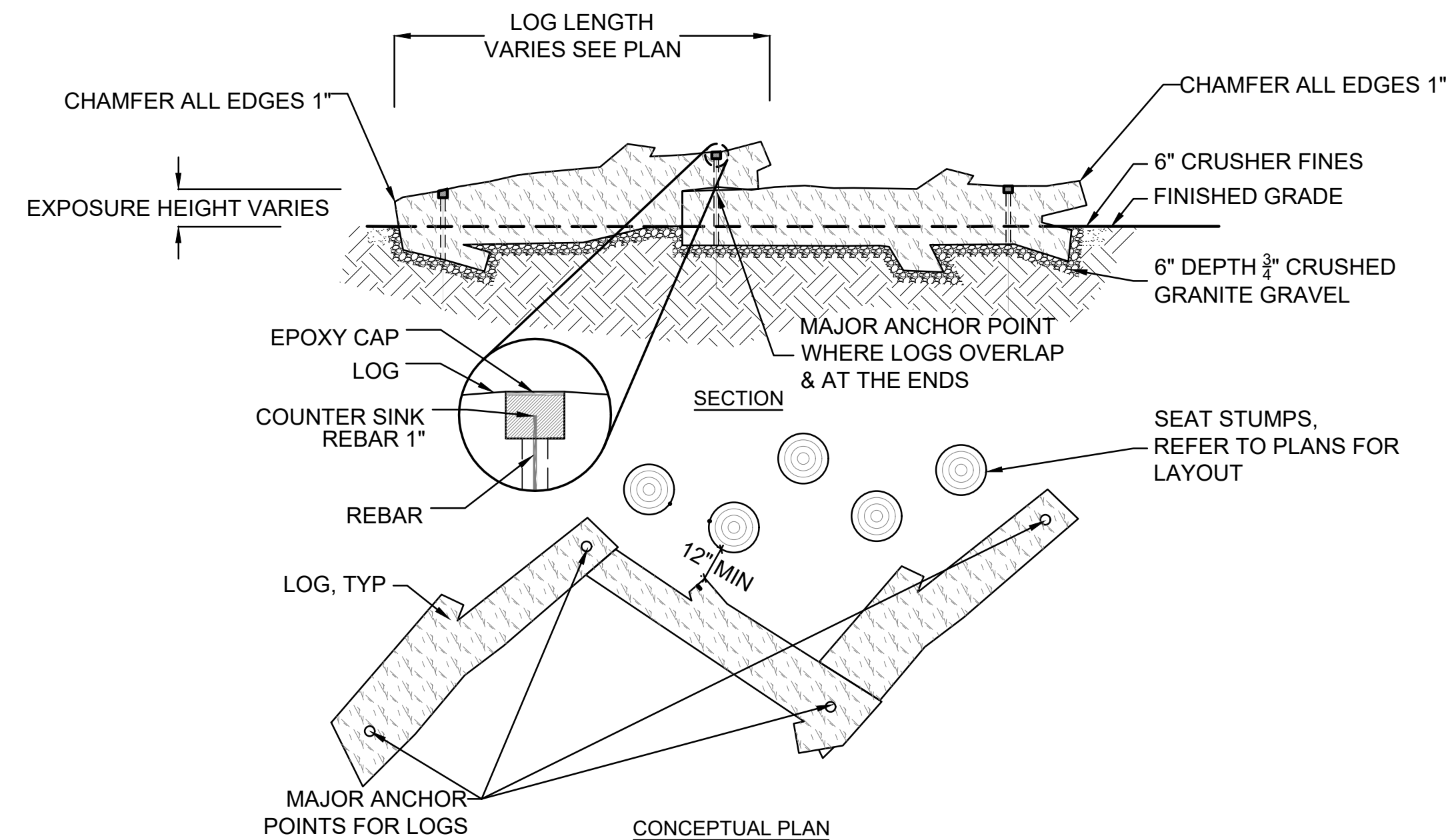

- NOTES:
- LOG SIZE AND SHAPE WILL VARY. ALL LOGS TO BE OF ROBINIA WOOD WITH BARK.
 - CONTRACTOR TO ENSURE ALL LOG STEP EDGES ARE SANDED AND FREE FROM SPLINTERS. REMOVE ALL BRANCHES WITH LESS THAN 6" DIAMETER AND TRIM BRANCHES TO NO LONGER THAN 3" IN LENGTH. CHAMFER ALL EDGES 1".
 - CONTRACTOR TO PLACE LOGS SO THAT NO GAPS OR OPENINGS ARE PRESENT BETWEEN THE LOG AND FINISHED GRADE AND NO OPENINGS ARE PRESENT THAT COULD CAUSE DEBRIS TO BECOME ENTANGLED. CONTRACTOR TO COORDINATE WITH PROJECT MANAGER PRIOR TO FINAL PLACEMENT.
 - ALL SURFACES SHALL BE SEALED WITH A MARINE GRADE SEALANT.
 - CONTRACTOR TO PROVIDE MOCK-UP OF PROPOSED ANCHOR AND INSTALLATION SYSTEM FOR APPROVAL BY PROJECT MANAGER PRIOR TO INSTALLATION.

G ZIG ZAG LOG BENCH DETAILS

NTS

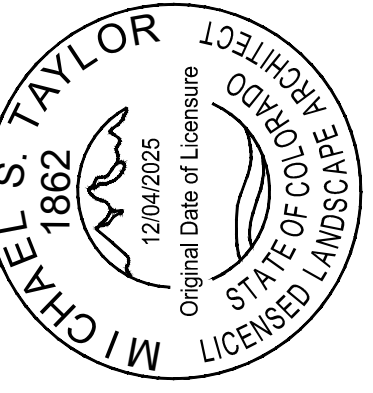

303-423-6036
rickengineering.com
5690 WEBSTER STREET
ARVADA, CO 80002
SAN DIEGO ORANGE RIVERSIDE SACRAMENTO SAN LUIS OBISPO
SANTA CLARITA PHOENIX TUCSON LAS VEGAS DENVER
PROJECT NO: 2209D
DRAWN/DESIGNED BY: MC
DATE: 05/07/2026
CHECKED BY: MST/TH

CHERRYWOOD PARK - PHASE 1
PLAYGROUND REVITALIZATION
CITY OF THORNTON
13607 MADISON STREET, THORNTON, CO 80602
LANDSCAPE DETAILS - 2



DRAWING NO.
LD-02
SHEET NO. 07 OF 10

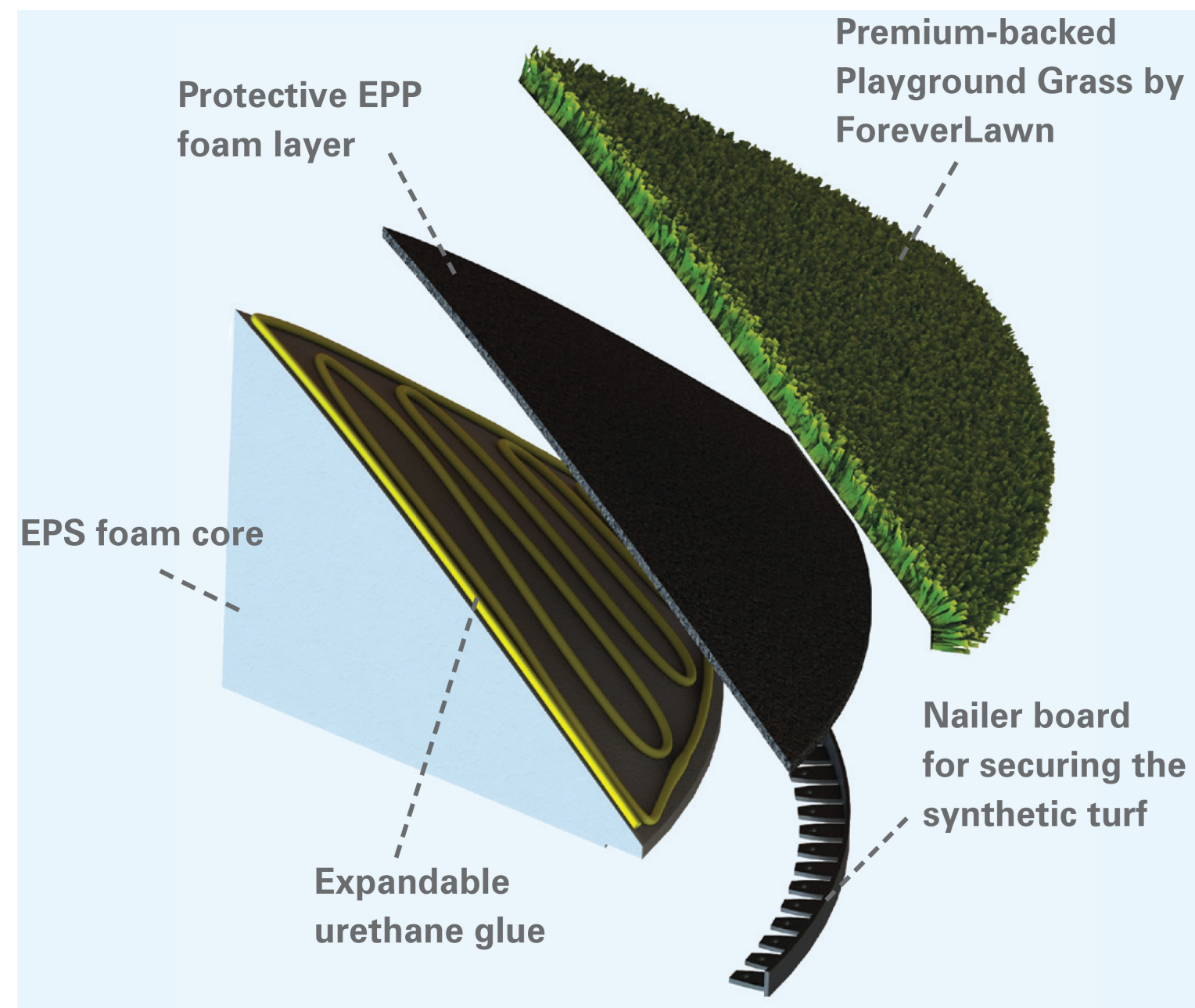

MANUFACTURER: FOREVERLAWN
OR APPROVED EQUAL
NAME: CUSTOM MOUND
TURF: PLAYGROUND GRASS
OR APPROVED EQUAL
COLOR: GREEN

CONTRACTOR TO PROVIDE SHOP
DRAWINGS FOR REVIEW AND APPROVAL

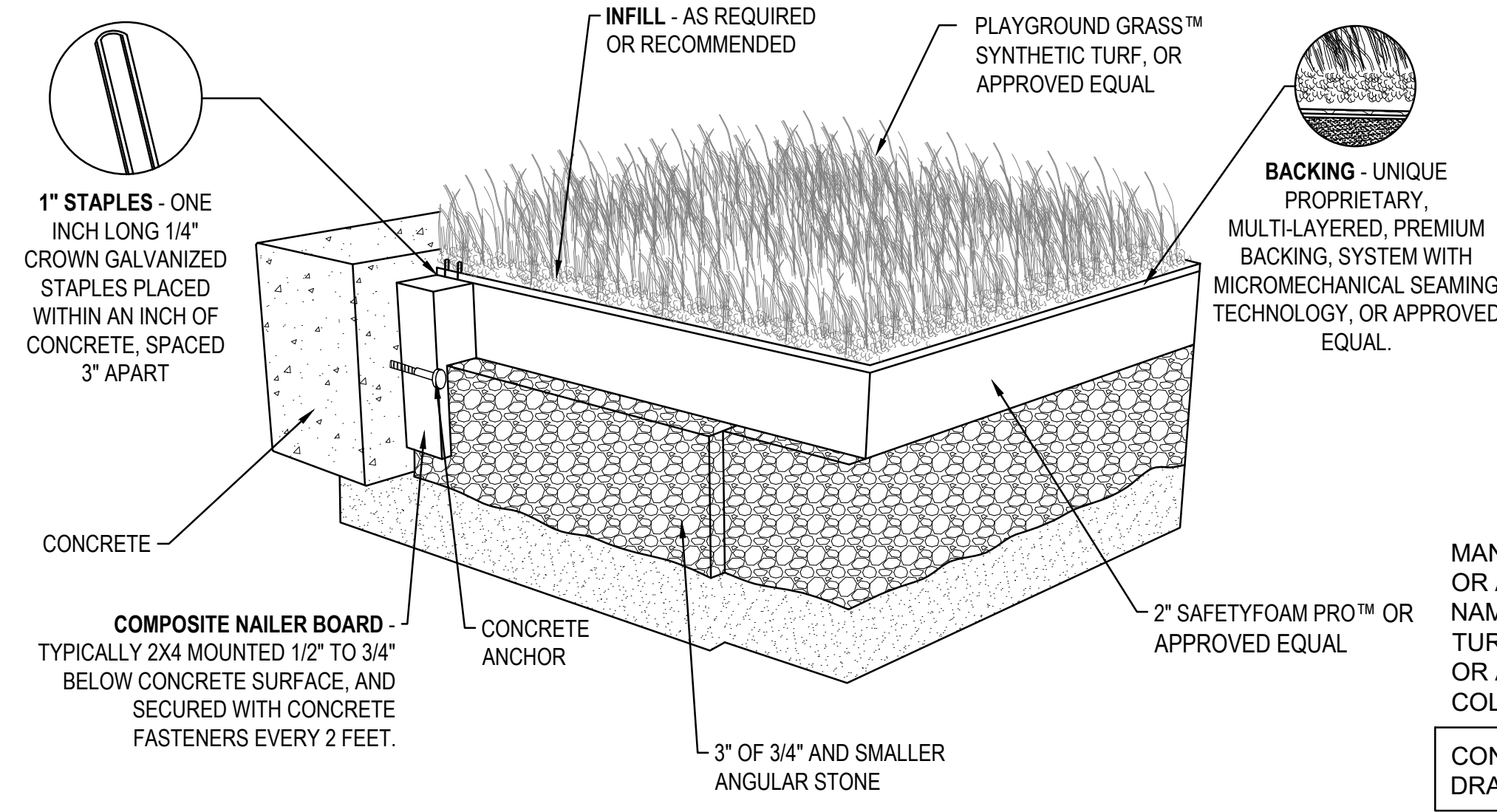

MANUFACTURER: FOREVERLAWN
OR APPROVED EQUAL
NAME: CUSTOM MOUND
TURF: PLAYGROUND GRASS
OR APPROVED EQUAL
COLOR: GREEN

CONTRACTOR TO PROVIDE SHOP
DRAWINGS FOR REVIEW AND APPROVAL

A ARTIFICIAL TURF MOUND CONSTRUCTION NTS

B ARTIFICIAL TURF OVER SAFETYFOAM PRO NTS

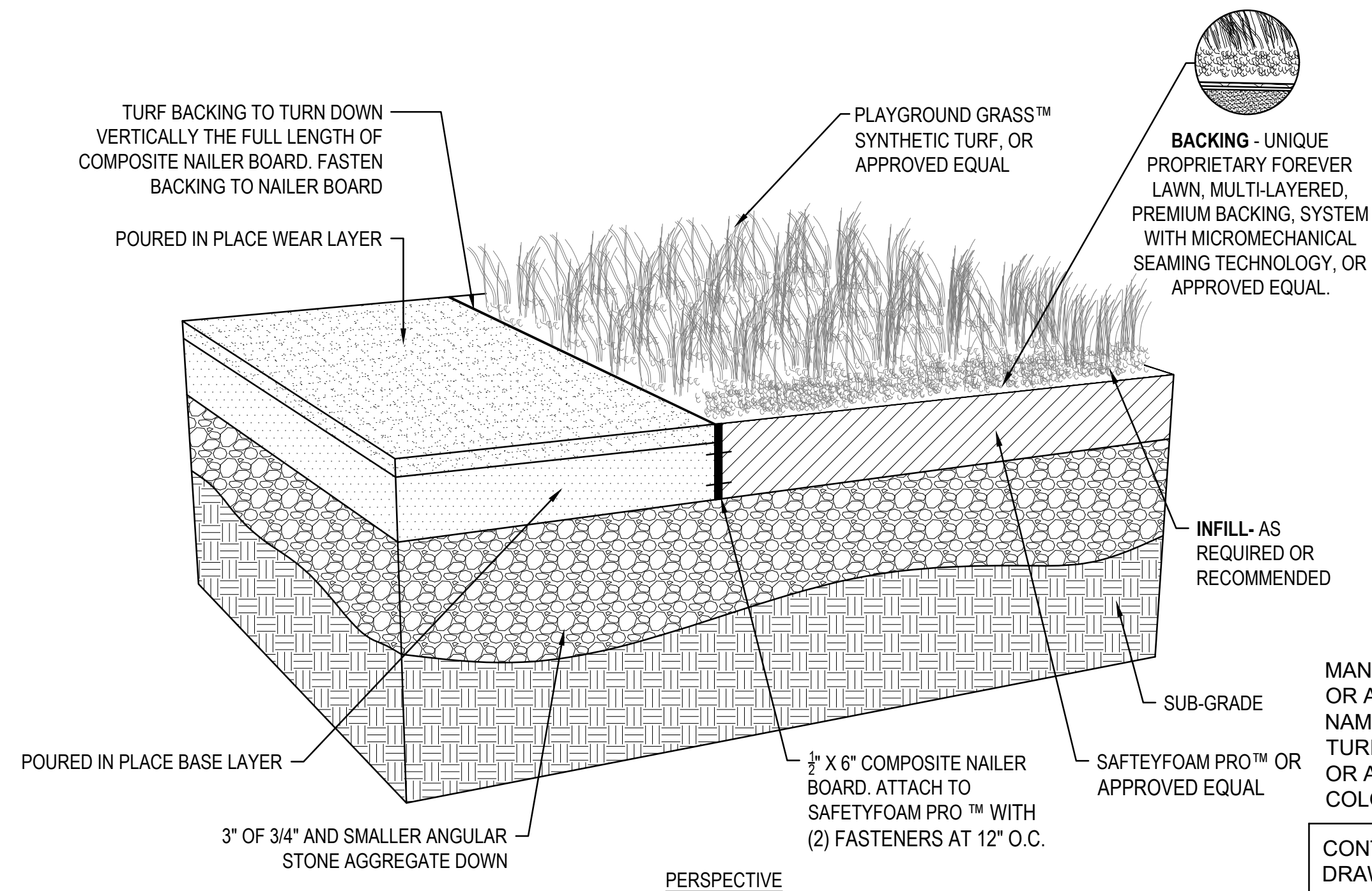

MANUFACTURER: FOREVERLAWN
OR APPROVED EQUAL
NAME: CUSTOM MOUND
TURF: PLAYGROUND GRASS
OR APPROVED EQUAL
COLOR: GREEN

CONTRACTOR TO PROVIDE SHOP
DRAWINGS FOR REVIEW AND APPROVAL

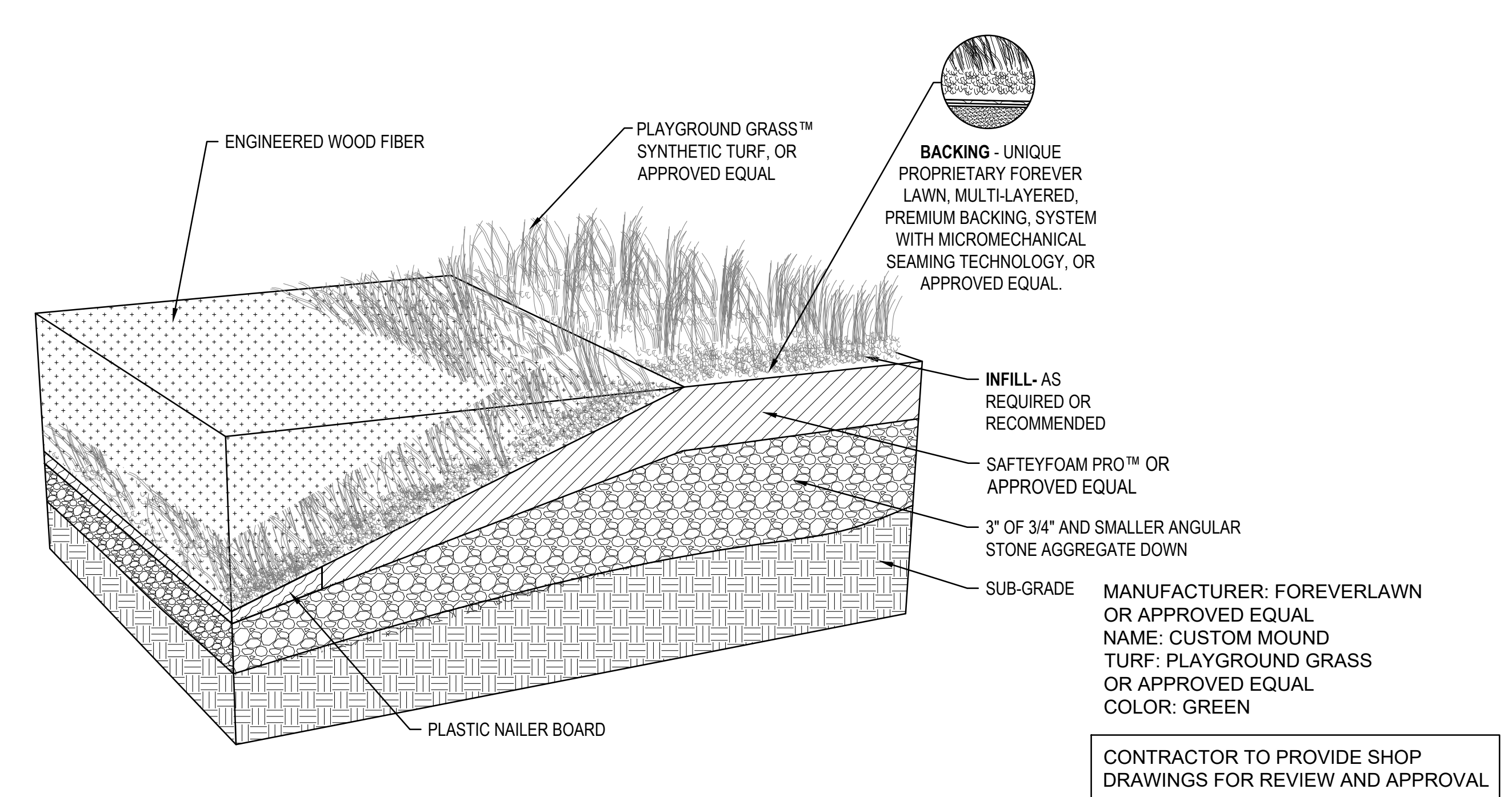

MANUFACTURER: FOREVERLAWN
OR APPROVED EQUAL
NAME: CUSTOM MOUND
TURF: PLAYGROUND GRASS
OR APPROVED EQUAL
COLOR: GREEN

CONTRACTOR TO PROVIDE SHOP
DRAWINGS FOR REVIEW AND APPROVAL

C ARTIFICIAL TURF TO Poured IN PLACE TRANSITION NTS

D ARTIFICIAL TURF TO ENGINEERED WOOD FIBER TRANSITION NTS

MANUFACTURER: FOREVERLAWN
OR APPROVED EQUAL
NAME: CUSTOM MOUND
TURF: PLAYGROUND GRASS
OR APPROVED EQUAL
COLOR: GREEN
CONTACT: DENA PARKER
EMAIL: DENA@FORREVERLAWNMILEHIGH.COM

CONTRACTOR TO PROVIDE SHOP
DRAWINGS FOR REVIEW AND APPROVAL

C ARTIFICIAL TURF MOUNDS AND TUNNEL WITH SLIDE AND SHADE POLE PASS-THRU NTS

5690 WEBSTER STREET ARVADA, CO 80002 303-423-6036 rickengineering.com	SAN DIEGO ORANGE RIVERSIDE SACRAMENTO SAN LUIS OBISPO SANTA CLARITA PHOENIX TUCSON LAS VEGAS DENVER
RICK	PROJECT NO: 2209D DATE: 05/07/2026 DRAWN/DESIGNED BY: [Name] CHECKED BY: [Name]
CHERRYWOOD PARK - PHASE 1 PLAYGROUND REVITALIZATION CITY OF THORNTON 13607 MADISON STREET, THORNTON, CO 80602	LANDSCAPE DETAILS - 3
	DRAWING NO. LD-03 SHEET NO. --- OF 10

C:\RICK\Projects\LD02000\2209-D-CherrywoodPark_Landscape\4_FDP\7_Sheets\2209D-LSDETAIL.dwg - plotted by: mcase ON 2026-05-07 @ 14:54 - c:\rrec_ncs_v2.ctb - © 2026 Rick Engineering Company

C:\RICK\Projects\LD02000\2209--D_CherrywoodPark_Landscape_4_FDP_V_Sheets\2209D-LSDETAIL.dwg - plotted by: mcose ON 2026-05-07 @ 14:54 - cbrrec_ncs_v2.ctb - ©2026 Rick Engineering Company

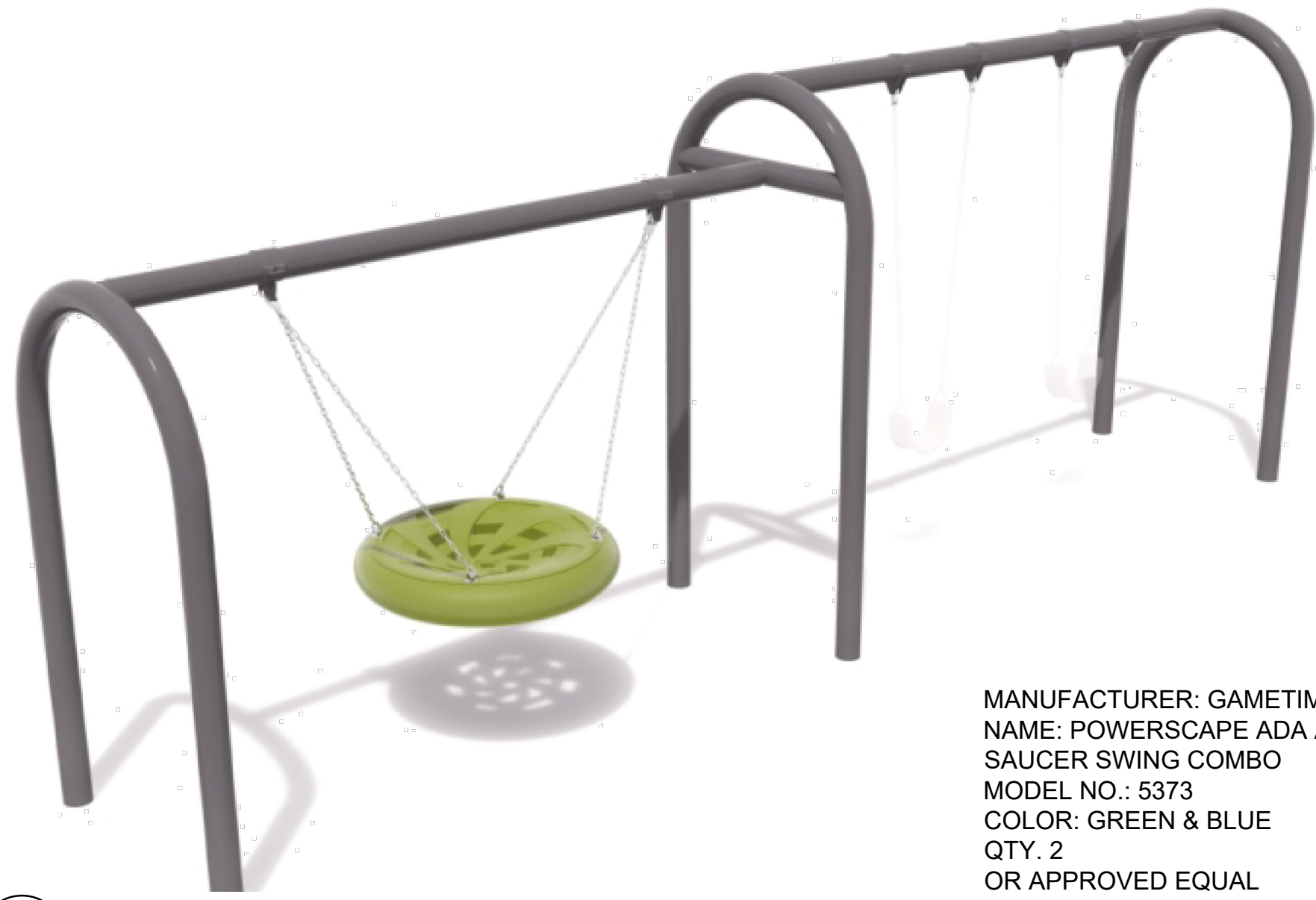

MANUFACTURER: GAMETIME
NAME: POWERSCAPE ADA AND SAUCER SWING COMBO
MODEL NO.: 5373
COLOR: GREEN & BLUE
QTY. 2
OR APPROVED EQUAL

A GAMETIME SWINGS: DISK BASKETS

NTS



MANUFACTURER: GAMETIME
NAME: EXPRESSION SWING WITH ADAPTIVE 8"
MODEL NO.: 5299
COLOR: GREEN & BLUE
QTY. 1
OR APPROVED EQUAL

B EXPRESSION SWING WITH ADAPTIVE SEAT

NTS



MANUFACTURER: GAMETIME
NAME: EXPRESSION SWING TANDEM 8"
MODEL NO.: 5297
COLOR: GREEN & BLUE
QTY. 1
OR APPROVED EQUAL

C EXPRESSION SWING TANDEM

NTS



MANUFACTURER: GAMETIME
NAME: 50' SKYRUN ZIP TRACK WITH ZERO-G SEAT
MODEL NO.: 91781
COLOR: GREEN & BLUE
QTY. 1
OR APPROVED EQUAL

D GAMETIME ZIPLINE ADAPTIVE SEAT

NTS



MANUFACTURER: GAMETIME
NAME: G6 SPINNER
MODEL NO.: 6310
COLOR: GREEN & BLUE
QTY. 1
OR APPROVED EQUAL

E GAMETIME SPINNER SEAT

NTS



MANUFACTURER: GAMETIME
NAME: ROXALL SEE SAW
MODEL NO.: 6245
COLOR: GREEN & BLUE
QTY. 1
OR APPROVED EQUAL

F GAMETIME ROXALL SEE SAW

NTS



MANUFACTURER: GAMETIME
NAME: POWERSCAPE ROLLER SLIDE
MODEL NO.: 6203SP
COLOR: BLUE & GREEN
QTY. 1
OR APPROVED EQUAL

G GAMETIME ROLLER SLIDE

NTS

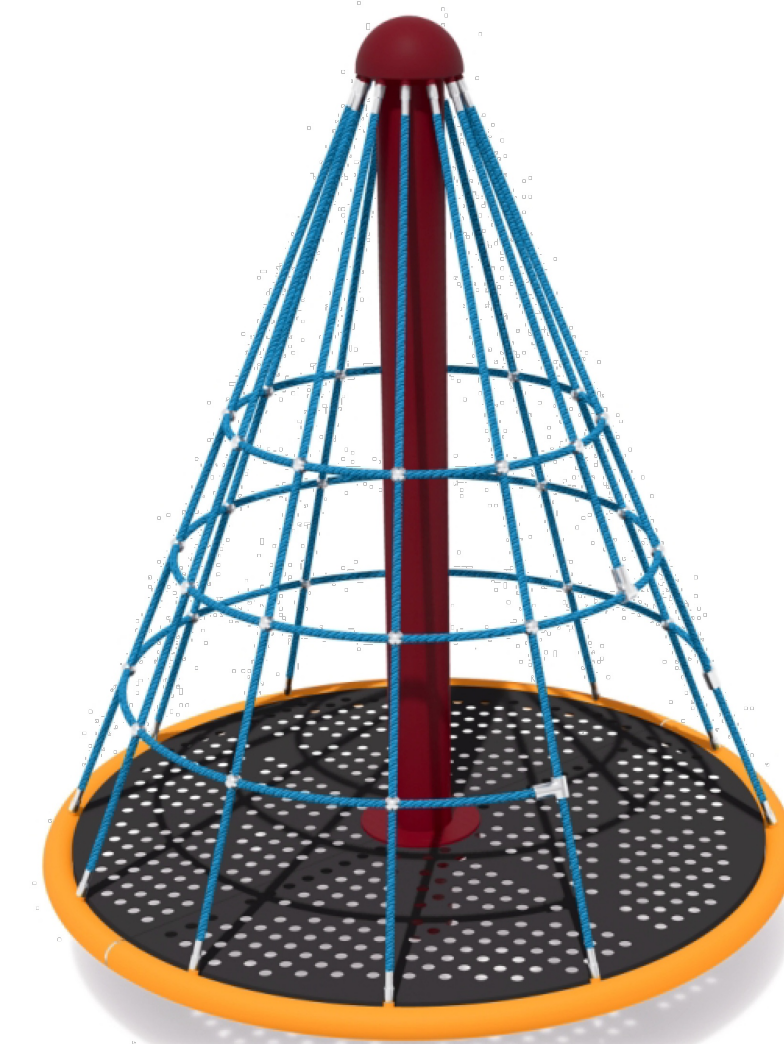

MANUFACTURER: GAMETIME
NAME: VISTATREE TOP 1
MODEL NO.: 5958SP
COLOR: GREEN & BLUE
QTY. 1
OR APPROVED EQUAL

H GAMETIME VISTA TREE TOP

NTS



MANUFACTURER: GAME TIME
NAME: HEX POD STEP
MODEL NO.: 90766
COLOR: GREEN & BLUE
QTY. 4
OR APPROVED EQUAL

I GAMETIME HEX POD STEP

NTS

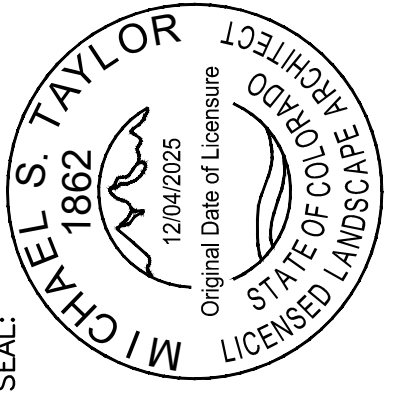

SEAL: MICHAEL S. TAYLOR
1862
12/04/2025
STATE OF COLORADO
LICENSED LANDSCAPE ARCHITECT

303-423-6036
rickengineering.com

5690 WEBSTER STREET
ARVADA, CO 80002

SAN DIEGO ORANGE RIVERSIDE SACRAMENTO SAN LUIS OBISPO
SANTA CLARITA PHOENIX TUCSON LAS VEGAS DENVER

PROJECT NO.: 2209D | DRAWN/DESIGNED BY: MC
DATE: 05/07/2026 | CHECKED BY: MST/TH

CHERRYWOOD PARK - PHASE 1
PLAYGROUND REVITALIZATION
CITY OF THORNTON
13607 MADISON STREET, THORNTON, CO 80602

LANDSCAPE DETAILS - 4

811
Know what's below.
Call before you dig.

DRAWING NO.
LD-04
SHEET NO. 09 OF 10

C:\RICK\Projects\LD02000\2209-D-CherrywoodPark_Landscape_4_FDPV7_Sheets\2209D-LSDETAIL.dwg - plotted by: mcose ON 2026-05-07 @ 14:54 - ctbrec_ncs_v2.ctb - © 2026 Rick Engineering Company



MANUFACTURER: GAMETIME
 NAME: CUSTOM STRUCTURE
 COLOR:
 QTY. 1
 CONTACT: ANGELA BOESE,
 ALTITUDE RECREATION
 OR APPROVED EQUAL

A GAMETIME CUSTOM PLAY STRUCTURE

NTS



MANUFACTURER: GORIC
 NAME: DJEMBE DRUMS
 SET OF 3
 QTY. 1 SET
 OR APPROVED EQUAL

B DJEMBE DRUMS

NTS



MANUFACTURER: PERCUSSION PLAY
 NAME: CYCLONE GROUND INSTALL
 COLOR: BLACK & WHITE
 QTY. 1
 OR APPROVED EQUAL

C CYCLONE

NTS



MANUFACTURER: GORIC
 NAME: STONE ABACUS
 MATERIALS: WOOD POSTS
 QTY. 1
 OR APPROVED EQUAL

D STONE ABACUS

NTS



MANUFACTURER: GORIC
 NAME: TUBULAR BELLS
 COLOR: N/A
 QTY. 1 SET
 OR APPROVED EQUAL

E TUBULAR BELLS

NTS



MANUFACTURER: PERCUSSION PLAY
 NAME: PENTATONIC TEMBOS
 GROUND INSTALL
 COLOR: N/A
 QTY. 1
 OR APPROVED EQUAL

F PENTATONIC TEMBOS

NTS

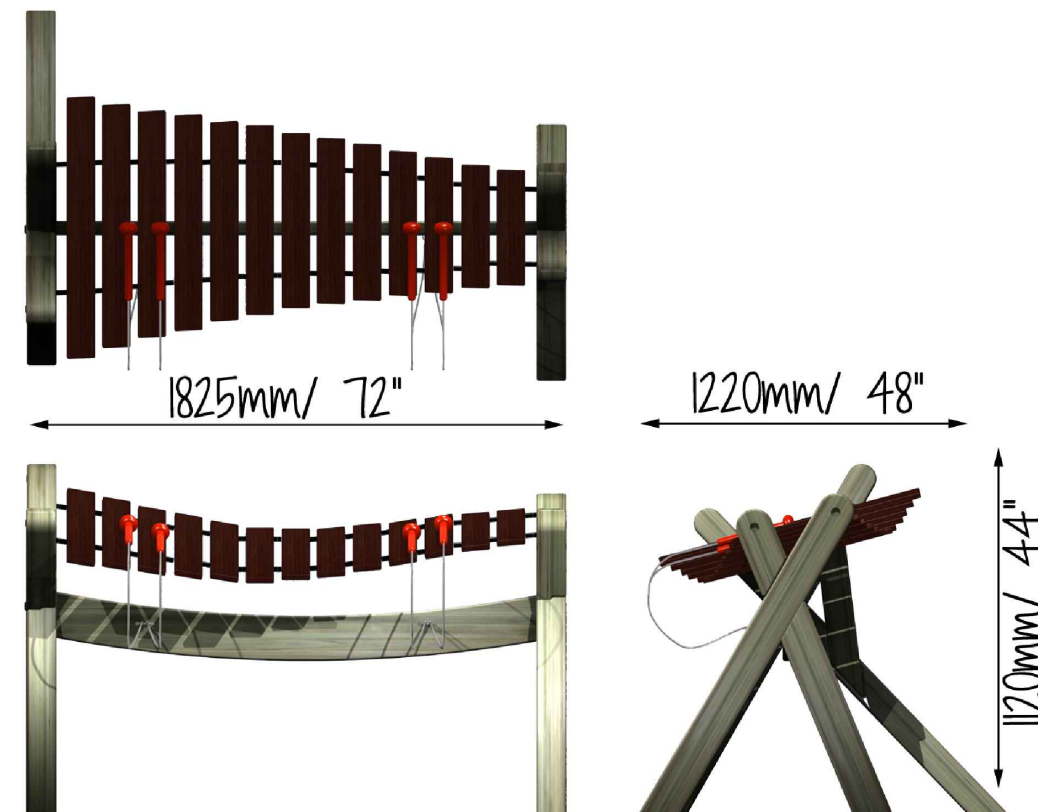

MANUFACTURER: GAMETIME
 NAME: POWERSCAPE ADA AND
 SAUCER SWING COMBO
 MODEL NO.: 5373
 COLOR:
 QTY. 1
 OR APPROVED EQUAL

G AKADINDA MARIMBA

NTS



MANUFACTURER: GAMETIME
 NAME: 10' DIA HEX UMBRELLA
 MODEL: QR1154
 QTY: 3
 COLORS:
 (1) TRUE BLUE
 (2) BOTTLE GREEN
 (3) SUN BLAZE
 OR APPROVED EQUAL

H CENTER POST SHADE

NTS

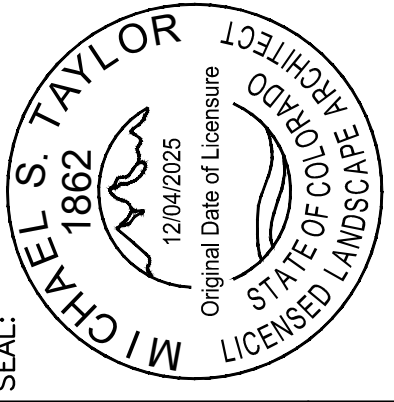

SEAL: MICHAEL S. TAYLOR
 1862
 12042025
 Original Date of Licensure
 STATE OF COLORADO
 LICENSED LANDSCAPE ARCHITECT

303-423-6036
 rickengineering.com
 5690 WEBSTER STREET
 ARVADA, CO 80002

SAN DIEGO ORANGE RIVERSIDE SACRAMENTO SAN LUIS OBISPO
 SANTA CLARITA PHOENIX TUCSON LAS VEGAS DENVER

PROJECT NO: 2209D | DRAWN/DESIGNED BY: MC
 DATE: 05/07/2026 | CHECKED BY: MST/TH

CHERRYWOOD PARK - PHASE 1
 PLAYGROUND REVITALIZATION
 CITY OF THORNTON
 13607 MADISON STREET, THORNTON, CO 80602

LANDSCAPE DETAILS - 5



DRAWING NO.
LD-05
 SHEET NO. 10 OF 10